



# Electronic Service Manuals

This electronic document is provided as a service to our customers. We do not create the contents of the information contained in this document. Should you have detailed questions pertaining to the information contained in this document, you may contact Michco, or the manufacturer which provided the original information in this electronic deliverable. Michco's only part in this electronic deliverable was the electronic assembly process.

You may contact Michco through the following methods:  
Phone (517) 484-9312 or (800) 331-3339 MI, OH, IN only  
2011 N. High St. -- Lansing, Michigan -- 48906  
Fax: (517) 484-9836  
Email: [CustServ@Michco.com](mailto:CustServ@Michco.com)  
Web site: [www.Michco.Com](http://www.Michco.Com)  
Parts Web site: [www.FloorMachineParts.Com](http://www.FloorMachineParts.Com)

Order Parts on Line at:  
**[www.FloorMachineParts.Com](http://www.FloorMachineParts.Com)**

Directly to Parts & Service:  
By Email: **[Shop@Michco.com](mailto:Shop@Michco.com)**  
By Fax: (517) 702-2041  
By Voice: Use numbers above.

**Serving the Cleaning Industry Since 1922**

Notice: All copyrighted material remains property of original owners, all trademarks are property of respective owners. Manuals are subject to Manufacturer's reproduction limitations. Originals or reproductions were provided by manufacturers through a request. We make no warranty as to the correctness of information provided in this document and you assume all risk.

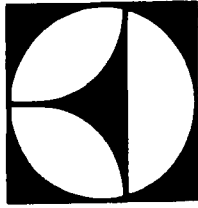

# KENT

**KA-261B**  
**MODEL KA-261BST**  
26" BATTERY AUTOMATIC

AND

**KA-321B**  
**MODEL KA-321BST**  
32" BATTERY AUTOMATIC

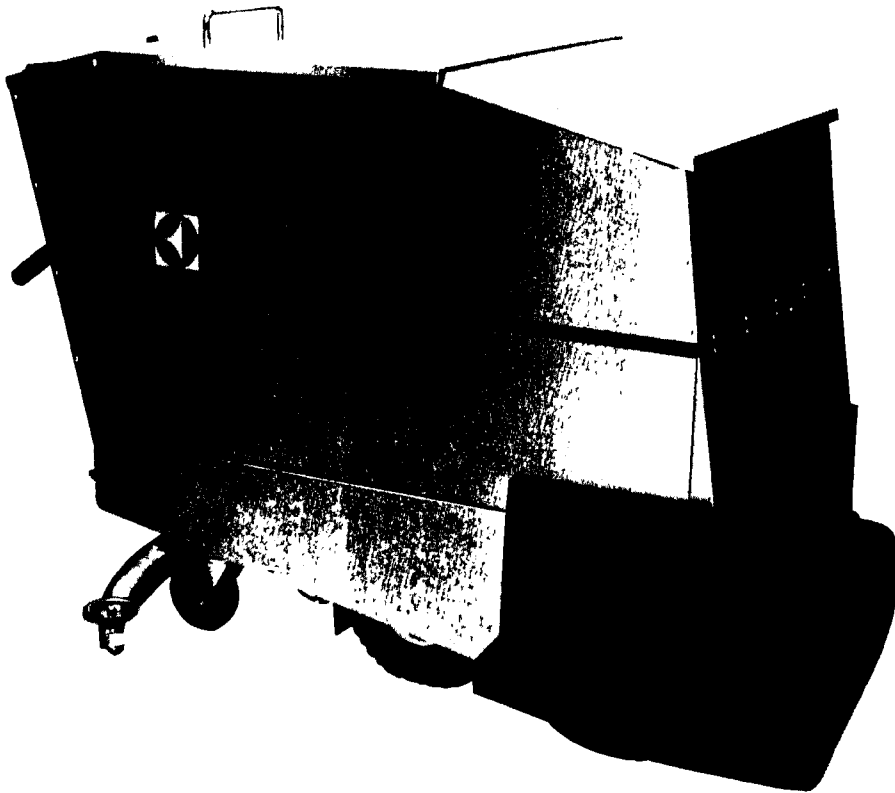

## OPERATING, MAINTENANCE INSTRUCTIONS & ILLUSTRATED PARTS LIST

NOVEMBER 1984

Write the model and serial number of your vacuum in the space provided Refer to the rating plate on cleaner.

Model #

Serial #

Retain this owner's guide for future reference.

### THE KENT COMPANY

P.O. Box 1665  
2310 Industrial Parkway  
Elkhart, IN 46514 (219)293-8661

Western Branch: 9865 South Pioneer Blvd.  
Santa Fe Springs, CA 90670 (213)949-9351

## INTRODUCTION

Your automatic has been especially engineered and manufactured to give the maximum in performance during scrubbing and polishing of large floor areas

With careful maintenance according to the instructions outlined in the following pages, a high standard of operation throughout its use will be insured

**Carefully inspect all components to insure that there is no concealed freight damage. If such damage is discovered, file a "CONCEALED DAMAGE REPORT" immediately with the delivering carrier.**

The contents of this Manual are based on the latest product information available at the time of publication. The right is reserved to make changes at any time without notice, in materials, equipment, price color, specifications and models



**CAUTION**

**IMPORTANT SAFEGUARDS: ACCIDENTS DUE TO MISUSE CAN ONLY BE PREVENTED BY THOSE USING THE MACHINE. TO GUARD AGAINST INJURY, BASIC SAFETY PRECAUTIONS AS SHOWN IN THIS MANUAL SHOULD BE OBSERVED.**

**READ AND FOLLOW ALL SAFETY INSTRUCTIONS.**

## CONTROL PANEL

1. Battery meter The needle must be within the GREEN area for efficient operation
2. Water flow control knob.
3. Main DRIVE "ON-OFF" switch with red indicator light.
4. "ON-OFF" switch for VACUUM motor Red light indicates a full recovery tank

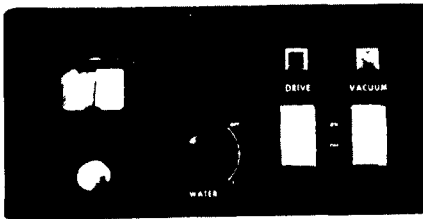

## MOTOR PROTECTION

### A. BRUSH DRIVE

On the rear panel directly beneath the traction control handles is a red Klixon overload switch. If the brush drive motors become overheated, the Klixon terminal overload will shut the motors off until they have cooled. If the brush drive motors will not turn on during operation, check to see if the Klixon has popped out. If so, wait for it to cool, push the Klixon switch in, and continue operating the machine.

### B. TRACTION DRIVE - 26" AUTOMATICS

On the rear panel directly beneath the traction control handles is a red Klixon overload switch. If the traction motor short circuited or overheated, the Klixon terminal

overload will shut the motor off until it has cooled. If the traction motor will not turn on during operation, check to see if the Klixon has popped out. If so, push the Klixon switch in, and continue operating the machine.

### C. VACUUM MOTOR

On the rear panel directly beneath the traction control handles is a white overload switch. If the vacuum motor circuit shorts out, the terminal overload will shut the motor off. If the vacuum motor will not turn on during operation, check to see if the breaker has popped out. If so, push the breaker button in, and continue operating the machine.

## TRACTION DRIVE OPERATION

### 26" AUTOMATICS

The forward motion of the machine is controlled by squeezing the control bar lightly for creeping motion, firmly for full speed. Reverse motion is controlled by pulling the control rod backwards, again lightly for creeping action, firmly for full reverse speed. The machine is equipped with a differential drive for easy turning in either direction.

### 32" AUTOMATICS

The forward motion of the machine is controlled by squeezing the control bar lightly for creeping motion, firmly for full speed.

For turns, squeeze the right side of the control and the machine will turn forward to the left. Squeeze the left side of the control bar for right turns.

The reverse motion of the machine is controlled by pulling the control bar backwards, again lightly for creeping motion, firmly for full reverse speed.

For reverse turns, pull the left side of the control and the machine will back up to the right. Pull the right side of the control rod for reverse left turns.

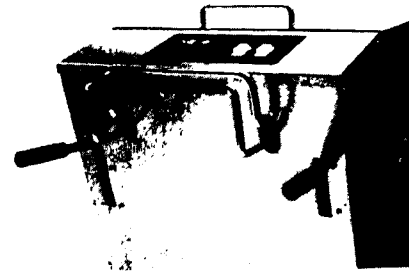

## SQUEEGEE OPERATION

On the rear panel, the right handle raises and lowers the squeegee. To raise the squeegee, pull the handle up and set it on the top of the ramp.

Push the squeegee handle down to lower the squeegee. This KENT automatic is equipped with a squeegee which is capable of swinging nine (9") inches to either side of the machine. This permits picking up of water on a turn because the squeegee will follow the pattern of the brushes. When up against a wall, the squeegee will ride tight to it until the machine pulls away. Should the squeegee encounter an obstruction, it will shift laterally until the obstruction has been passed.

## BRUSH CONTROL

To start and lower brushes

1. Push drive switch "ON"
2. The left handle is lowered for scrubbing operation
3. For heavy scrubbing and stripping operations, push the handle all the way down and set it on the bottom of the ramp



CAUTION:

PLACE MAIN SWITCH IN OFF POSITION BEFORE APPROACHING BRUSH COVER.

## INSTALLING THE BRUSHES

The KENT automatics come equipped with two scrub brushes which mount to the brush drive as follows

Each brush has 3 lugs located around a hole

To install brushes

1. Raise the brush mechanism to full up position
2. Remove brush cover by loosening two black knobs at front of machine
3. Under, each brush drive pulley is a slotted brush drive plate.
4. There are two aluminum pins chained to the two traction motors. Insert each pin through the holes provided in the brush head plate.
5. Place the 3 lugs on brush into the 3 slotted brush drive plate
6. Raise and rotate each brush with a sharp jerk toward the side of the machine. This will lock the brush lugs into the drive plate
7. Remove the aluminum pins, turn them over and store in holes in brush plate. Failure to remove pins will result in circuit breaker tripping or damage to the brush head

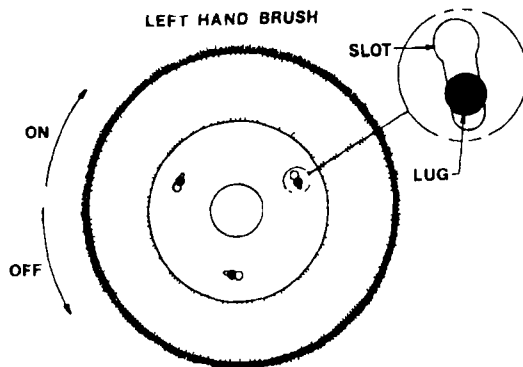

## SOLUTION TANKS

Raise the lid at the front of the machine. The fresh solution and the recovery tanks are mounted side by side. The right hand tank is the fresh solution tank and is marked "FILL HERE". The left is the recovery tank with a built in automatic float shut-off

## VACUUM MOTOR AND LINT FILTER

The vacuum motor and lint filter are located in the vac well of the recovery tank. They can be inspected by

(Turn off all switches)

1. Disconnect the vacuum motor plug
2. Remove the 2 vacuum motor tie down screws
3. Lift the vacuum motor and filter off the 2 studs
4. Remove the motor filter and clean the foam material and any lint on motor fan or louvers

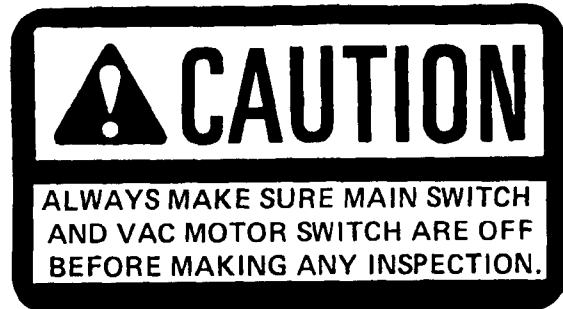

## MICROSTAT FILTER

(Optional) Package of 12 (Part 38303)

Installation

1. Remove the vacuum motor as in steps 1, 2, and 3 in instructions under Vacuum Motor
2. Place the Microstat Filter into the vacuum motor pot. Be sure to cover the entire gasket that is on the bottom of the pot. Replace and secure the vacuum motor

## WET FLOAT SHUT-OFF AND INDICATOR LIGHT

The wet float shut-off is located in the recovery tank. To inspect and clean, remove the vacuum motor pot from the recovery tank. NEVER RESTRICT THE WET FLOAT SHUT-OFF OR VACUUM MOTOR, FLOODING AND DAMAGE MAY OCCUR

When the recovery tank is full, the float shut-off will turn on the red vacuum light. When the red vacuum light comes on

1. Turn the vacuum 'OFF'
2. Take the machine to a dumping area and empty the recovery tank
3. Flush out the tank with clean water and check to see that the wet float is not restricted

## **INSTRUCTIONS IN USE OF YOUR KENT AUTOMATIC SEQUENCE OF SCRUBBING OPERATIONS**

To apply solution to the floor, scrub, and immediately recover the liquid and soil, the following sequence of operations is followed

1. Press the drive rocker switch to the 'ON' position
2. Turn the vacuum switch "ON"
3. Lower the squeegee
4. Turn water knob to desired flow rate.
5. Lower the brushes to the desired position, brush drive motors automatically turn 'ON'
6. Squeeze the control rod for forward motion. Various speeds of forward or reverse motion can be obtained by changes in force on the central rod. An infinite number of speeds are available. **DO NOT REVERSE MACHINE WITH SQUEEGEE DOWN**

### **TURNS IN THE NORMAL SCRUBBING PATTERN**

In order to reduce an over abundance of solution during operation on sharp turns

- (A) Turn water knob to 'OFF' six (6) feet before the turn  
(B) Return the water knob to 'ON' in the middle of the turn.

**KENT automatics can be easily controlled and maneuvered with one hand leaving the other hand free to manipulate the water flow. THIS FEATURE PLUS THE KENT SWING SQUEEGEE WILL REDUCE CLEAN UP TIME FOLLOWING THE SCRUBBING OPERATION**

This machine is equipped with an automatic shut-off device which will cease the operation of the pick-up tube when the recovery tank is full. You will note this condition when the red vacuum light is on. When this condition occurs, the squeegee and brushes should be raised from the floor with the vac motor shut off and the machine driven to a suitable area for dumping of dirty water

#### **TO DUMP SOLUTION:**

1. Raise the front machine lid and remove the vacuum motor pot
2. Go to the right side of the machine, reach **DOWN TO THE RIGHT DUMP VALVE** (red handle) and pull up

**NOTE** Stand well away from the valve for the soil will dump very fast

The left dump valve is for releasing the clean solution (Directions are from operators position)

### **DUMP HOSE KIT**

For conditions where a drain is not accessible, a dump hose kit (Part 38369) is available

**Please read and follow the daily, weekly, and monthly maintenance schedule located on THE UNDERSIDE OF THE LID OVER THE BATTERY COMPARTMENT.**

### **MACHINE CARE**

At the end of the day's operation, the machine should be completely cleaned and prepared for the next shift's operations. Careful maintenance will insure effective performance throughout a long period of service

1. Open the access to the recovery tank and completely rinse with clean water. If this is done at the end of each day, there will be no soil build-up to the surface of the polyethylene tank
2. Clean the fresh water tank using the same procedure as in No. 1 above
3. Do not store the machine with the brushes in down position because of the possible set in the brushes and possible discoloration of the floor due to moisture in the brushes
4. Tilt the battery compartment lid full forward and inspect the battery compartment to insure that no large amount of water or solution has gathered in the battery compartment tray
5. Remove the brushes from the machine, clean and dry them as necessary and wipe down exterior of the machine

### **MAINTENANCE INSTRUCTIONS**

A sound Preventive Maintenance Program will insure long, reliable and effective performance from your machine. We would strongly suggest that responsibility for the machine be assigned to a reliable individual in your organization

#### **DAILY**

1. Clean and flush fresh and recovery solution tanks
2. Clean lint filter on vac fan

3. Wipe squeegee blades and machine wheels clean
4. Wipe clean all interior and exterior surfaces
5. Check battery water level and clean tops with damp cloth - connect KENT battery charger
6. Charge batteries
7. Check pick-up tube for any obstruction

#### WEEKLY

1. Lubricate chain and check for tension
2. Lubricate all linkage and hinge parts See lubrication chart
3. Check pick-up tube for any obstructions
4. Lubricate caster bearings and axle See lubrication chart
5. Replace Microstat Filter (where applicable)

#### MONTHLY

1. Lubricate chain and check for tension
2. Lubricate all linkage or hinge pivot parts See lubrication chart
3. Check all belts and chains for tension and wear (See adjustments )
4. Check sprockets for wear
5. Check alignment of chain and belts
6. Check pick-up tube for any obstructions
7. Check and clean batteries per BATTERY MAINTENANCE
8. Check all gaskets,vacuum motor,vacuum pot,tank inlet tube,and water valve
9. Check proper clutch adjustments
10. Check traction bar control spacing
11. Check all wiring connections for cleanliness
12. Lubricate caster bearings and axle (See lubrication chart)
13. Replace Microstat filter (where applicable)
14. Check tire pressure (60 PSI)

#### SIX MONTHS

1. Same as Monthly plus
2. Inspect vacuum motor carbon brushes, replace if worn to 3/8" length or less
3. Inspect traction motor carbon brushes, replace if worn to 3/8"
4. Inspect brush drive motor carbon brushes, replace if worn to 3/8"

### ADJUSTMENTS - CONTROL BAR 32" AUTOMATICS

Traction Control Bar spacing is necessary when the traction control bars are not parallel or more or less than 1-3/4" apart SEE FIGURES ON NEXT PAGE

To adjust the spacing

1. Loosen both nuts on each of the control rod assemblies
2. Position the control rods so that they are 1-3/4" apart and parallel
3. Tighten both nuts at the bottom of the control rod assemblies

#### To adjust the Control Bar Centering Spring:

1. Remove the locking nut "L" and remove the control rod assembly "P"
2. Remove both wing nuts "B" Loosen the set screw in collar "H" and slide it away from the spring
3. Loosen the set screw in collar "G" centering the clutch linkage in between the clutches
4. BAR "E" SHOULD REMAIN EXACTLY CENTERED BETWEEN THE CLUTCHES
5. Replace control rod assembly "P" and adjust nuts "L" and "M" to establish 1-3/4" between the control bars
6. Replace wing nuts "B" and adjust the clutches (See Clutch Adjustment )

### CLUTCH ADJUSTMENT 32" AUTOMATICS

The 32" Automatic uses four clutches in the traction drive system Clutch adjustments are needed when

- a) Excessive movement of the control bar is needed to obtain forward or reverse motion
- b) The machine constantly pulls to one side

#### To adjust clutches:

1. All switches are turned "OFF"
2. Examine all of the clutch linkage for any wear or lost motion Replace as necessary
3. Apply a firm pressure at point "A" This will engage the clutch and remove lost motion Turn the wing nut "B" until there is 5/16" clearance between the wing nut "B" and the stop "E" Repeat the same procedures for each of the four clutches

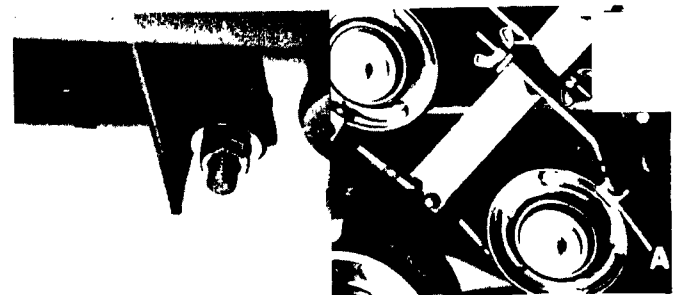

### AUTOMATICS

The 26" Automatics use a reversing motor and V-Belt in the traction drive Adjustments are needed in the following cases

- a) Excessive movement of the control bar is needed for forward or reverse motion
- b) If the machine does not stop when control bar is released (Self Propelling)

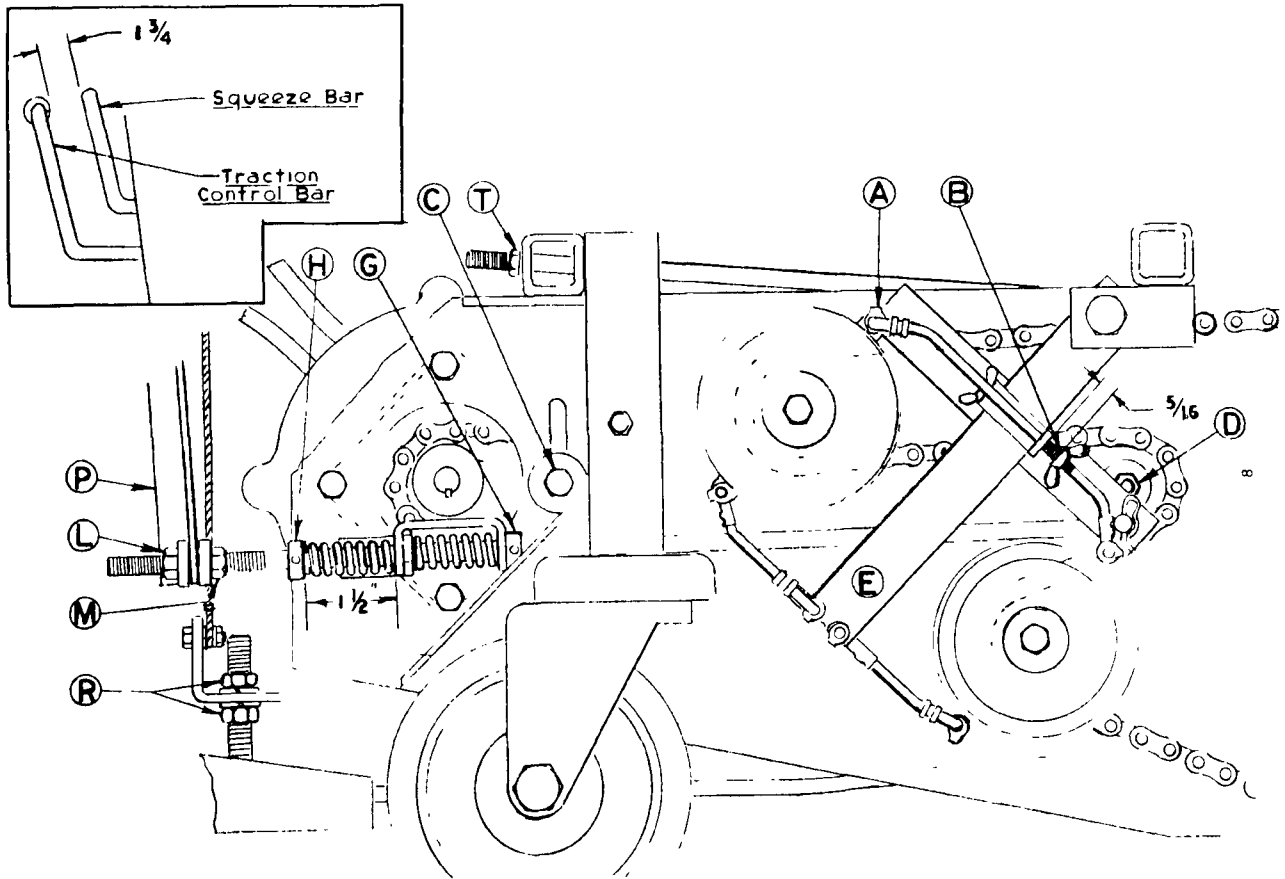

### TO ADJUST THE CABLE LINKAGE

1. Turn all switches off
2. Open battery compartment
3. Disconnect forward battery cable and place lead so that it will not come in contact with any battery post
4. Cover battery tops with cardboard or other non-conducting material
5. Remove instrument panel and carefully lay out on the cardboard sheet **DO NOT TOUCH ANY OF THE BATTERY TERMINALS.**
6. Push the control bar to forward and reverse positions and check for slack in the cable assemblies. When the control bar is in the forward position the rear cable assembly should be tight and the forward cable slack. When the control bar is in reverse the forward cable is tight and rear cable is slack. When the control bar is in neutral, both cables are slack. To adjust either cable assembly loosen the 1/4-20 hex nuts at each end of the cable assembly turnbuckle. Rotate the turnbuckle until the cable is tight when the control bar is in operating position and slack when the control bar is in any other position



**CAUTION**

**CAUTION: NEVER MAKE ADJUSTMENTS WITH MOTORS RUNNING! TURN MAIN SWITCH "OFF".**

### DRIVE CHAIN ADJUSTMENTS 32" AUTOMATICS

The primary drive chain is 3/8" pitch

The final drive chains (2) are 1/2" pitch

Before any adjustments are made, both the sprockets and chains should be inspected for wear

1 The primary drive chain is equipped with a self adjusting idler.

2 If the chain should become loose so that the idler can no longer take up the slack, replace the chain

**To adjust the final drive chains:**

1 Locate the self-locking nut on the sprocket mounted between the clutch linkage and the front tire

2 Use a 9/16" crowfoot wrench, loosen self-locking nut 1/4 turn. Slide the nut forward to tighten the chain

**NOTE:** There are 2 final drive chains, one on each side of the machine

**CAUTION:** Chains must have some slight slack for quiet and efficient operation. Do not overtighten

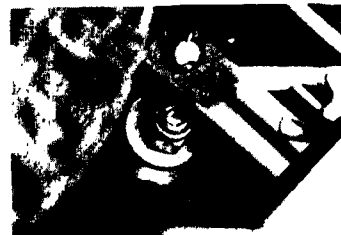

## DRIVE CHAIN ADJUSTMENTS 26" AUTOMATICS

1. Locate access hole on lower chassis assembly on left side of machine
2. Loosen bolt in access hole with ½" socket
3. Slide idler sprocket down until chain is snug
4. Retighten idler sprocket bolt

## SQUEEGEE PRESSURE ADJUSTMENT

At the rear of the machine, mounted directly above the squeegee, is a nut that secures the squeegee rod

To increase squeegee pressure

1. Use a ½" deep socket wrench
2. Turn the nut clockwise to increase squeegee pressure

## SQUEEGEE LIFT ADJUSTMENT

This adjustment is necessary when the squeegee will not clear the floor when the squeegee is in the "UP" position

To adjust the squeegee higher

1. Put the squeegee handle in the "UP" position
2. Loosen the bottom jam nut "R" clockwise until the squeegee is clear of the floor
3. Turn the top jam nut "R" clockwise until the squeegee is clear of the floor
4. Tighten the bottom jam nut "A" to lock the squeegee position

## USE OF THE BATTERY CHARGER

The Kent Battery Charger is of the constant current type and will drop and hold a finish rate of 2 to 3 amps until the timer has shut off. The charger is equipped with a Klixon circuit breaker for protection from short circuit or reverse polarity of the batteries

To operate the battery charger

1. Open the battery compartment lid. **Do not close this lid during charging operation.**
2. Connect the charger plug into the machine firmly. The charger plug is mounted in the battery compartment and beneath the control panel
3. Plug the battery charger into a normal electrical outlet and set the timer as desired

**Note:** Set the battery charger on a flat, hard surface to insure that cooling air can circulate through the bottom louvers

The battery charger is guaranteed against defective parts and workmanship. Any parts proving defective within six months will be repaired free of charge when the charger is returned prepaid to the manufacturer

## WARNING:



Hydrogen gas is formed when the batteries approach the full charge state. This gas is explosive; therefore when charging batteries with lid open, avoid any open flame or electric spark near batteries. This includes connecting or disconnecting charger with timer "ON". To avoid accumulation of gas, be sure batteries receive good air circulation while being charged.

## BATTERY CARE

Battery care determines the life span and efficiency of the units, therefore, for the longest possible useful life from these batteries, the following procedure should be followed

1. Keep battery solution (electrolyte) level up in cells. Check daily - if cells need water, use only distilled or approved water
2. Keep batteries fully charged
3. Keep batteries and connection clean. When necessary, clean with baking soda solution, attach wires and coat terminals with grease to retard corrosion

## SERVICE & BATTERY GUARANTEE APPLYING TO SCRUBBER-VAC BATTERIES

**SERVICE GUARANTEE:** If a battery becomes unserviceable in normal use within 90 days of purchase, the purchaser is entitled to a new battery of a comparable size and type, without charge, or to the necessary repairs, without charge for either labor or materials, at the option of the manufacturer. Transportation, recharges, or the use of rental batteries are not classed as repairs and the battery owner is expected to pay for such services, if required by user.

**ADJUSTMENT POLICY:** If a battery becomes unserviceable in normal use after the expiration of the service guarantee, but before the expiration of the battery guarantee, it will be repaired or replaced with another battery of a comparable size and type to the original purchaser, on a pro-rated price basis, in exchange for the unserviceable battery, the purchaser paying only for the service received, plus transportation charges.

**LIMITATIONS:** Failure in service due to fire, wreckage, explosion, freezing, abuse or neglect, use of battery "dopes", or the use of a battery of a group size smaller than of the battery used as original equipment is not covered by the Service & Battery Guarantee. The Service & Battery Guarantee will not apply if battery has been opened or repaired or manufacturer's identification markings has been obliterated before presentation for adjustment or if battery has broken case or cover or if battery is discharged.

# SCALE FOR PRO-RATING AFTER 90 DAYS

$$\frac{\text{Months Operation}}{\text{Months Guarantee}} \times \frac{\text{Price}}{1} = \text{Exchange Price}$$

All batteries are guaranteed for twelve (12) months from date of receipt

(Subject to change without notice)

## SERVICE DIAGNOSIS - MAINTENANCE CHECK LIST

PROBLEM	HOW TO CORRECT	PROBLEM	HOW TO CORRECT
<b>MACHINE WILL NOT MOVE</b> 1 Loose wire 2 Battery condition low 3 Clutch requires adjustment (KA 321B) 4 Cable linkage requires adjusting (KA 261B)	1 Reconnect 2 Check voltmeter and charge batteries 3 See Clutch Adjustment Page 7 4 See Adj. Cable Linkage Page	<b>WATER WILL NOT COME ON</b> 1 Water line disconnected 2 Cable is loose on water valve	1 Reconnect water solution line to brush head 2 Tighten cable to valve
<b>BRUSH DRIVE MOTOR WILL NOT START</b> 1 Disc Drive Switch Ref 5 Fig B 2 Loose wire 3 Battery condition low 4 Thermal Protector tripped 5 Pins left in brush plate tripping thermal protector	1 Replace switch 2 Reconnect 3 Reset by pushing red button See Page 1 4 Remove pins and store in holes in frame	<b>MACHINE PULLS TO ONE SIDE</b> 1 Squeegee dragging only on one side 2 One clutch over driving the other (KA 321B only) 3 Low tire pressure 4 Readjust linkage (KA 321B only)	1 Examine squeegee rod 2 Adjust clutch per instructions in this catalog Page 7 3 Increase tire pressure to 60 lbs
<b>MACHINE STREAKING A CLEANED FLOOR</b> 1 Foreign materials lodged under rear squeegee blade 2 Insufficient water flow to brushes 3 Worn squeegee blades 4 Worn discs 5 Uneven squeegee pressure	1 Raise squeegee and clean blade 2 Clean screen in fresh solution tank and eliminate any restrictions in lines 3 Replace squeegee blade 4 Replace discs 5 See Squeegee Adjustment, Page 9	<b>MACHINE CREEPS</b> 1 Clutch out of proper adjustment (KA 321B only) 2 Linkage requires lubrication (KA 321B only) 3 Linkage out of adjustment (KA 261B)	1 Adjust clutch per instructions in this catalog Page 7 2 Lubricate all linkage pivot points 3 Adjust linkage per instructions in this catalog
<b>VACUUM SUCTION BLOCKED</b> 1 Clogged pick up tube 2 Lint Filter Ref No 36 Fig C dirty 3 Air leaks around vac motor 4 Clogging at elbows and hose entering recovery tank	1 Remove accumulations 2 Clean lint filter 3 Examine gasket for damage or warped motor well 4 Remove elbow and clean	<b>SQUEEGEE LEVER DOES NOT PICK UP</b> 1 Squeegee cable off of pulleys 2 Squeegee height requires adjustment	1 Place cable in pulleys once again 2 See adjustment instructions in the catalog
<b>SHORT OPERATING TIME</b> 1 Battery charge condition very low 2 Constant disc operation high pressure adjustment 3 Corroded wires or connectors	1 Recharge batteries fully before beginning operations 2 Use high pressure more sparingly 3 Clean thoroughly	<b>CHARGER WILL NOT COME ON</b> 1 DC or AC cords not connected 2 Fuse defective 3 Polarity reversed	1 Connect 2 Replace fuse No. 26795 3 Correct situation so voltmeter on instrument panel reads correctly
<b>KLIXON PROTECTOR KEEPS TRIPPING</b> 1 Motor overloaded (KA 321B only) 2 Pins left in brush plate 3 Pads or brushes rubbing	1 Adjust studs on head pressure rod 2 Remove pins and store in holes in frame 3 Install original equipment accessories	<b>TIRE MARKS ON FLOOR</b> 1 Low tire pressure	1 Pump tires to 60 lbs of pressure (Optional foam filled tire replacement available)
		<b>CONTROL BAR WILL NOT RETURN (KA 261B) TO NEUTRAL</b> 1 Return springs disconnected 2 Return spring set, or missing	1 Reconnect spring 2 Replace spring(s)

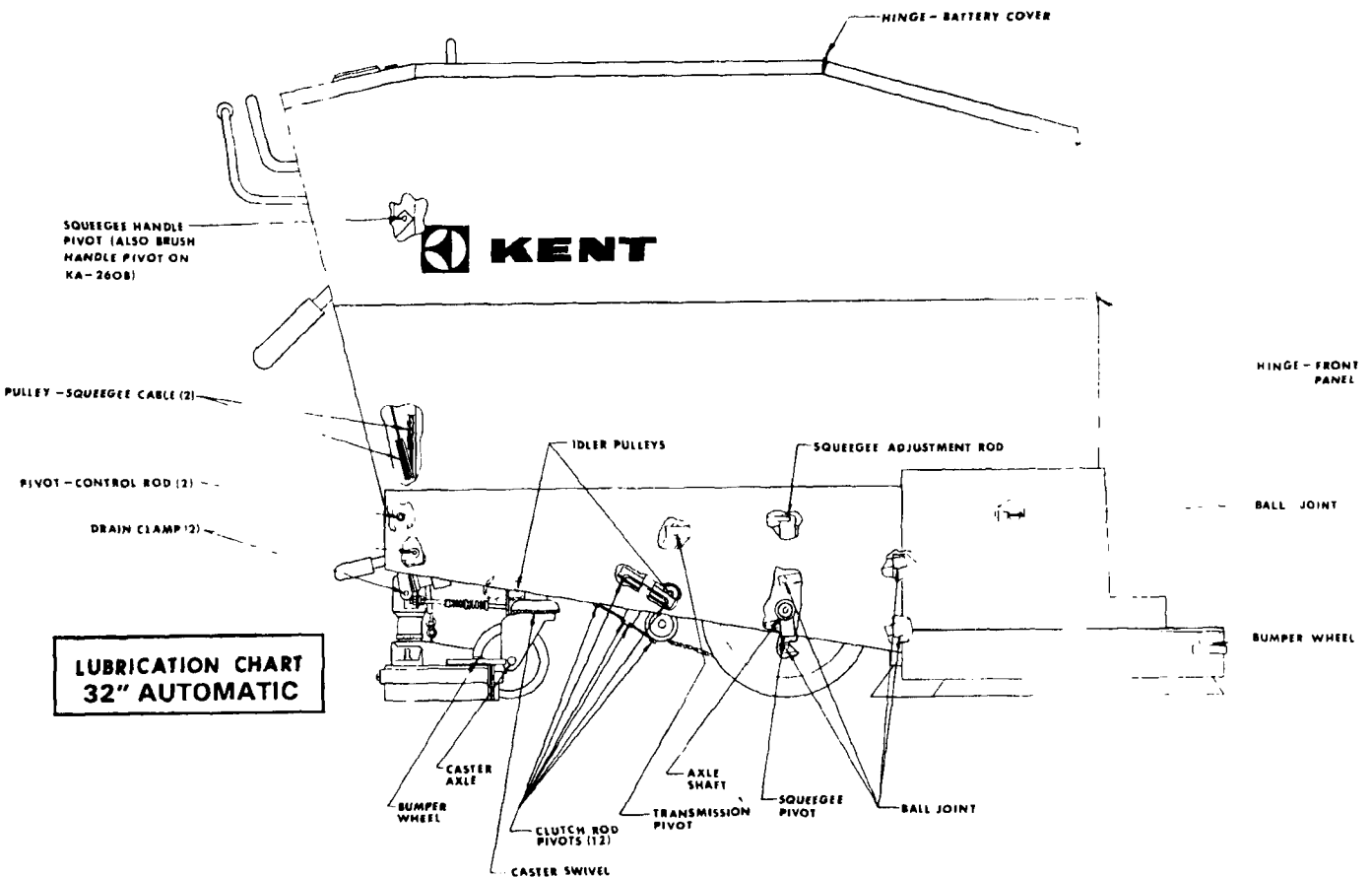
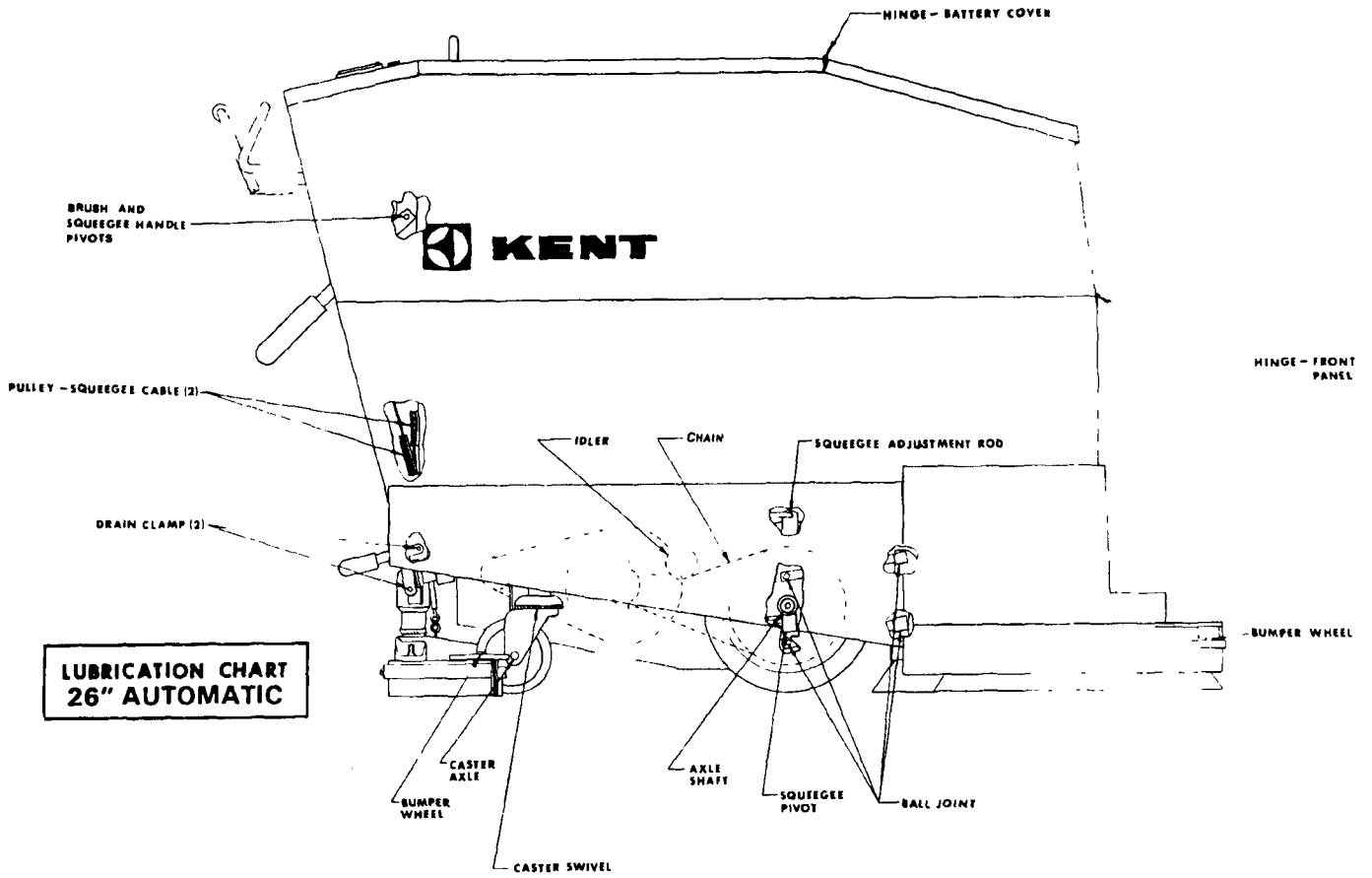

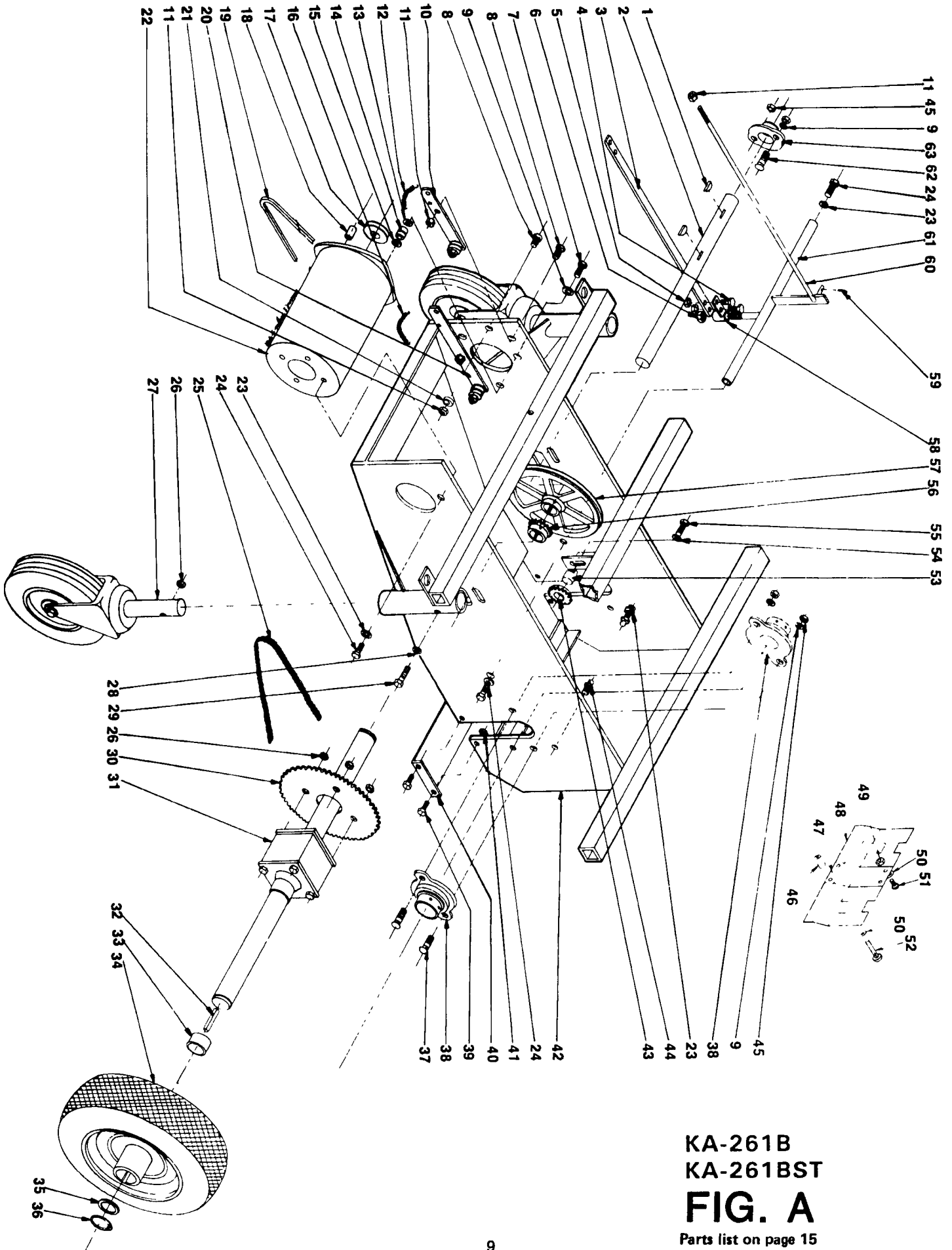

KA-261B  
 KA-261BST  
**FIG. A**  
 Parts list on page 15

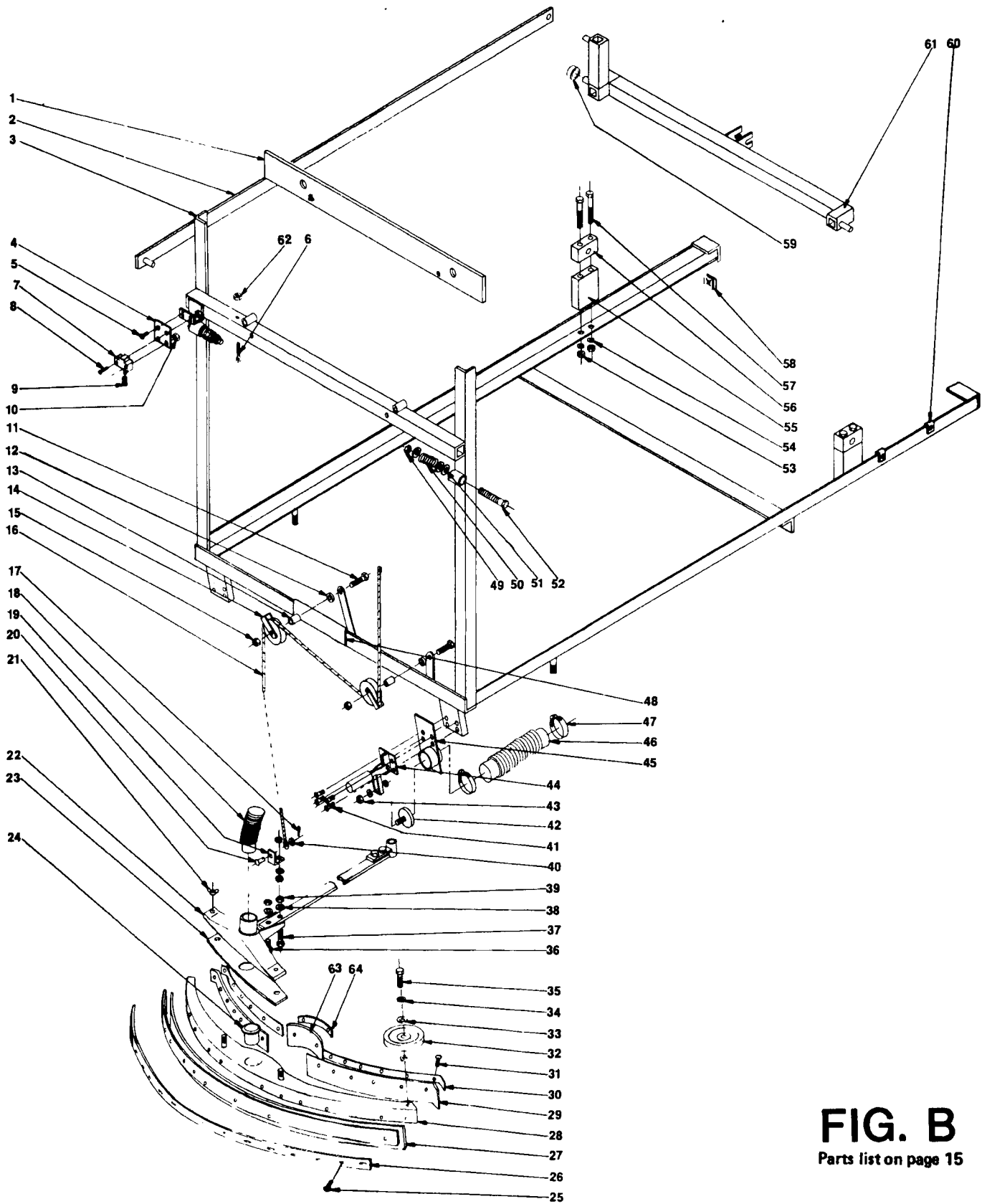

# FIG. B

Parts list on page 15

KA-261B  
KA-261BST

# KA-261B & KA-261BST

## FIG. C

Parts list on page 16

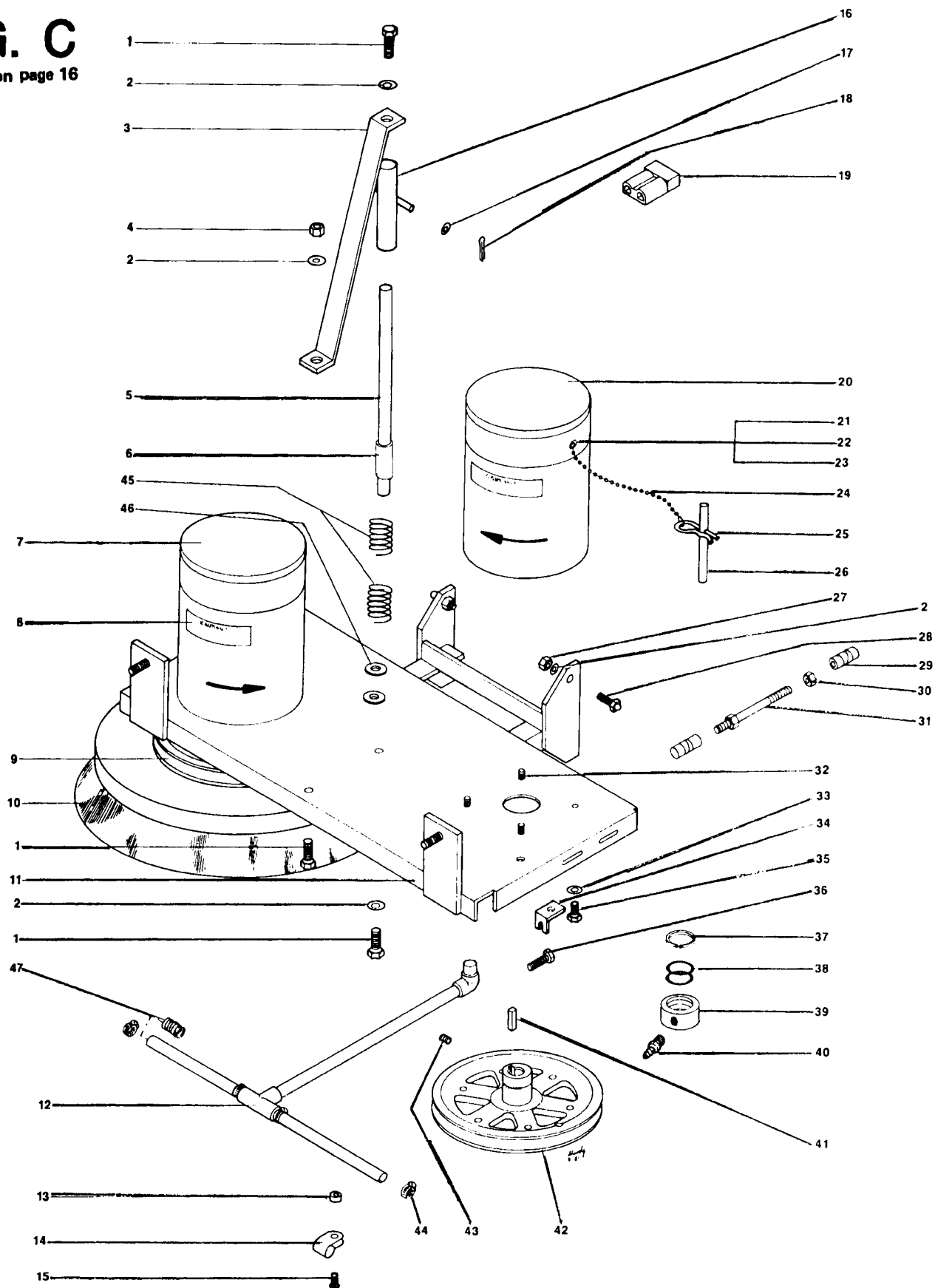

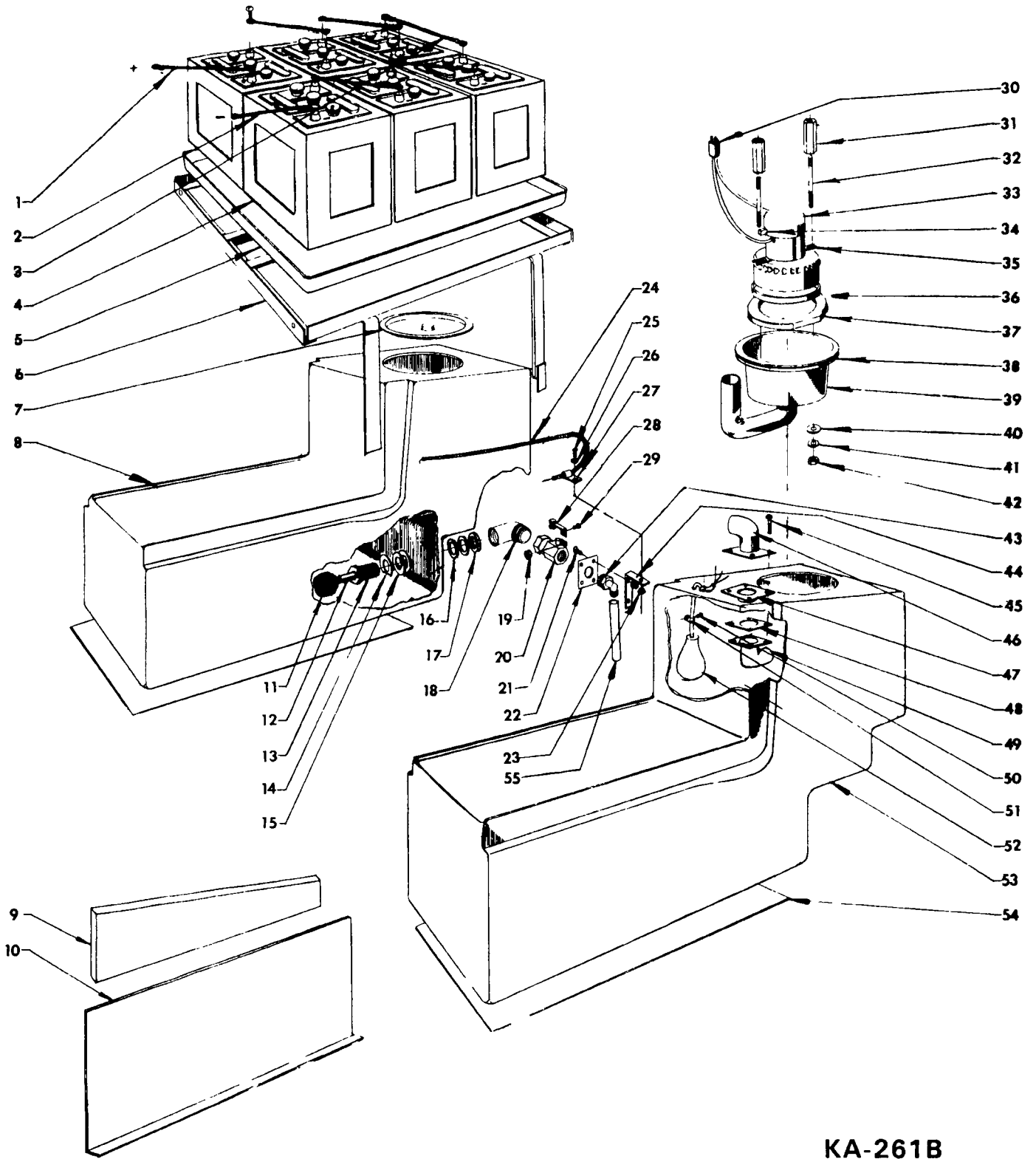

KA-261B  
 KA-261BST  
**FIG. D**  
 Parts list on page 16

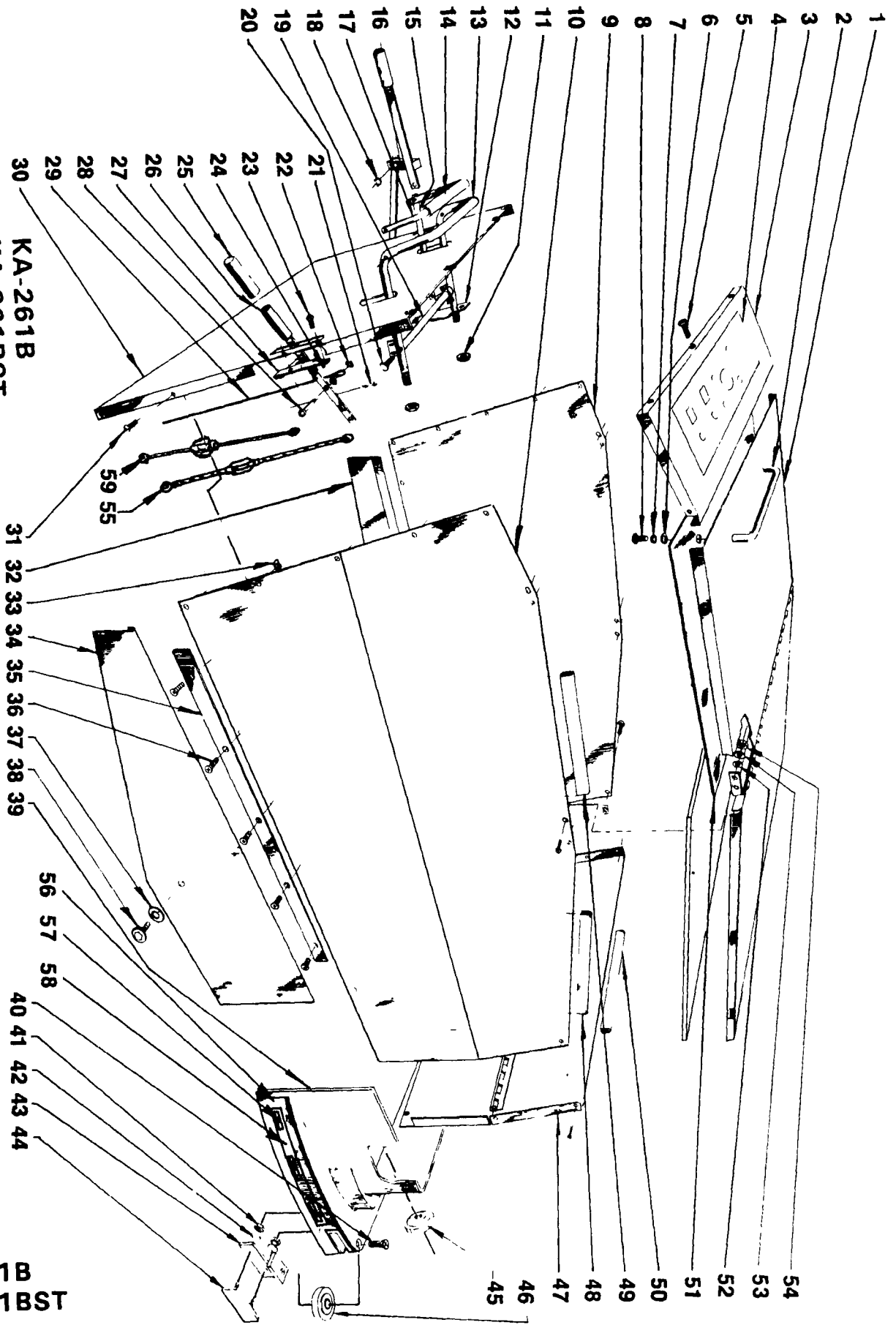

KA-261B  
KA-261BST  
FIGURE - E

KA-261B  
KA-261BST

**FIG. E**

Parts list on page 17

KA-261B  
 KA-261BST  
**FIG. F**  
 Parts list on page 17

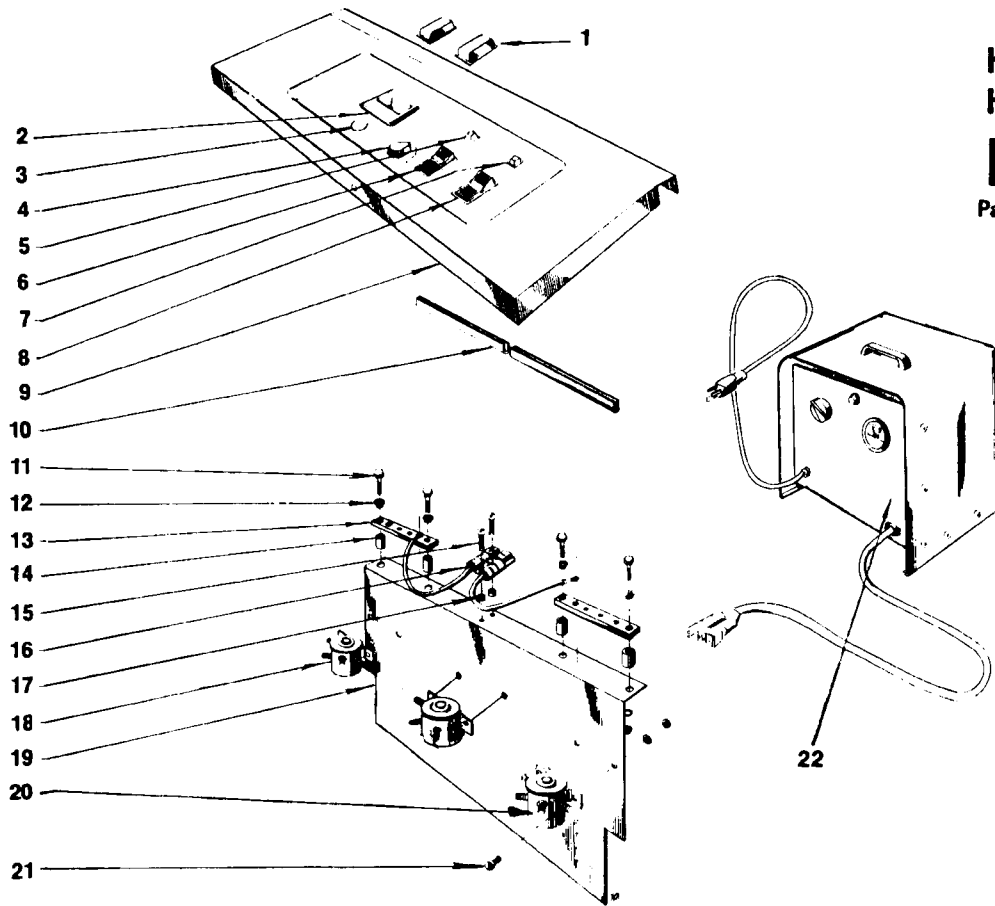
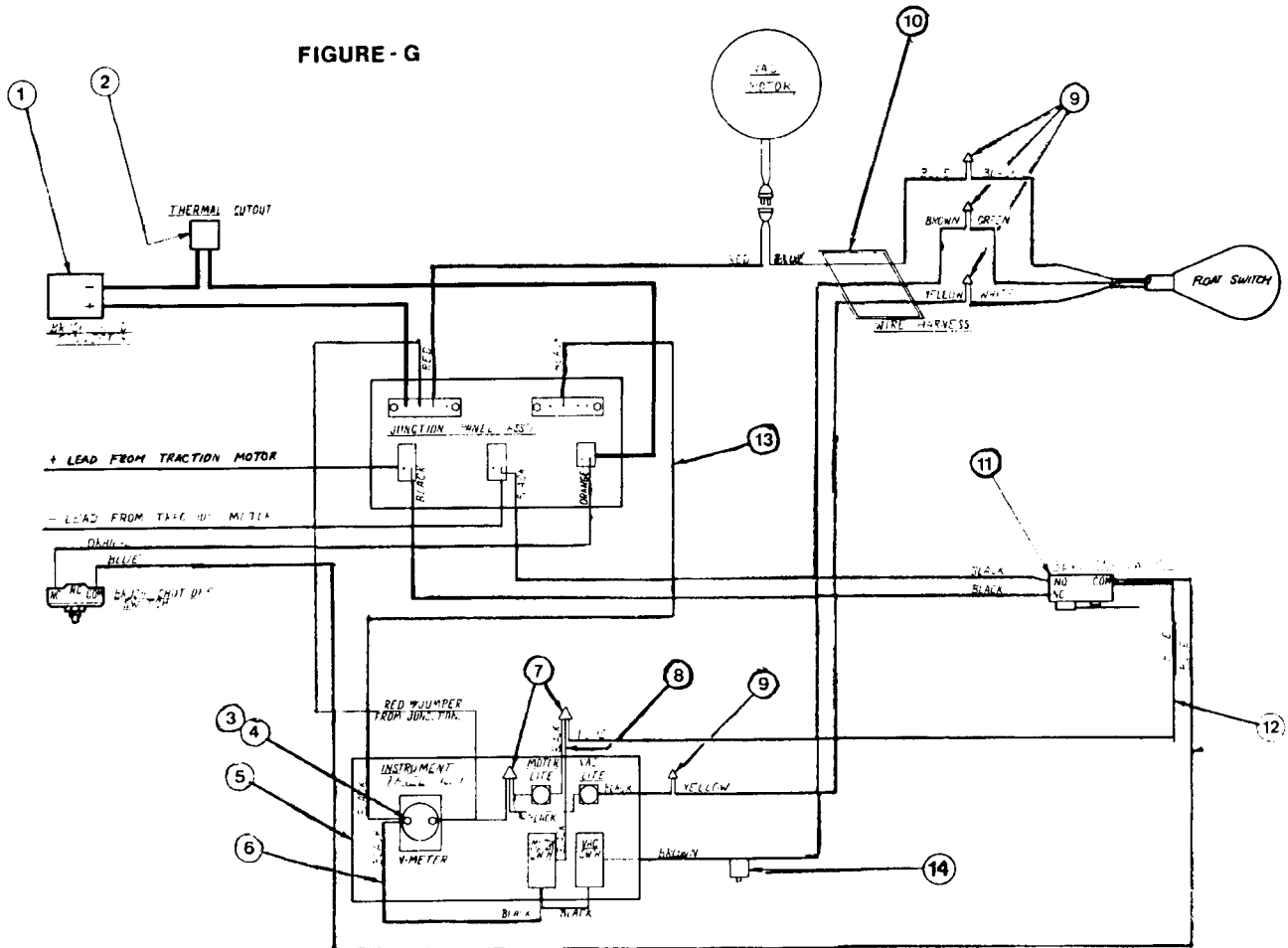

FIGURE - G



KA-261B & KA-261BST FIG. A

SEQ NO	COMPONENT	DESCRIPTION	QUANT PER
1	049017	KEY,WOODRUFF--#606,.750D,.187W	2
2	051393	SHAFT,BELT--DRIVE KA261B	1
3	051423	BAR,STL--.250X1.25X18.50L,SPR	1
4	003249	SCR CAP HEX HD .312-18X1.25L	2
5	003349	NUT,HEX--.312-18,ZN PLT	2
5	004212	WSHR LK .3261D.5860D.078TSPLT	2
6	003370	NUT,HEX LOCK--.500-13,ZN PLT	1
7	003252	SCR CAP HEX HD .312-18X2.00L	2
8	003246	SCR CAP HEX HD .312-18X1.00L	3
9	004212	WSHR LK .3261D.5860D.078TSPLT	10
10	033770	ASM,BELT--TENSIONER UPPER	1
11	003378	NUT,HEX LOCK--.312-18,ZN PLT	4
12	051479	SPRING,EXT .500D 2.25L .049WD	1
13	049377	SPACER,STL--.315X.500,.280L	1
14	027190	BRG,BALL--.3151D,.8660D,.276W	2
15	052591	SPACER,STL--.315X.500,.368L,Z	1
16	052647	SPRING,EXT--.531D 3.89L .054WD	1
17	051570	SHEAVE--ZINC PLATED'OUT-SERV'	1
18	052576	SPACER,STL--.500X.750,1.200L,Z	1
19	051489	BELT,V--A WIDTH,32.25PL	1
20	033771	ASM,BELT TENSIONER--AUTO'S	1
21	052654	DATA PLATE--KT-200P,2.30/50ELUX	1
22	051388	MTR,MODIFIED--23308 W/FLG CUT	1
23	004214	WSHR LK .3901D.6830D.094TSPLT	7
24	003228	SCR CAP HEX HD .375-16X.875L	3
25	051421	CHAIN,ROLLER--#40, 6RLK & CONN	1
25	051608	LINK,OFFSET--#40 ROLLER CHAIN	1
26	003283	NUT,HEX--.250-20,ZN PLT	6
27	049940	CASTER	2
28	002278	WSHR LK .2621D.4890D.062TSPLT	2
29	002273	SCR CAP HEX HD .250-20X1.75L	2
30	051376	SPROCKET,CHAIN--#40,.500P,44T	1
31	051375	DIFFERENTIAL,DRIVE--KA261B	1
32	044656	KEY,SQUARE--.250 SQ,2.500 LONG	2
33	051417	SPACER,STL--1.01X1.25,.463L	2
34	051395	WHEEL,DRIVE--4.10/3.50-5	2
35	004330	WSHR FLT 1.051D1.500D.036T STL	6
36	040537	RING,RTNG--EXT,.984 SHAFT,5160	2
37	003251	SCR CAP HEX HD .312-18X1.75L	4
38	027221	BRG,BALL,ANLR,SLD--SELF ALGN.	2
39	003224	SCR CAP HEX HD .375-16X.750L	4
40	051394	SUPPORT,PLATE--LOWER KA-261B	1
41	005279	NUT,HEX LOCK--.375-16,NYLUC	4
42	033406	WDMT,CHASSIS--LOWER	1
43	049003	SPROCKET,CHAIN--#40,.500P,11T	1
44	048953	BALL JOINT	4
45	003349	NUT,HEX--.312-18,ZN PLT	8
46	050872	SPACER,PHEN--.750X.500,.375L	2
47	052408	PLATE,MTG--SPLASH GUARD 4.0X7	1
48	052200	RUBBER,SPLSH GUARD--8.18X14.75	1
49	005480	NUT,HEX LOCK-- 10-24,NYLUC	2
50	224015	WSHR FLT .1871D1.000D.061T STL	4
51	001289	SCR MACH RD HD 10-24X.500L	2
52	005482	SCR TPG F PAN HD 10-24X.875L	2
53	048216	RING,RTNG--EXT,.625 SHAFT,5100	1
53	052483	IDLER SHAFT--MOTOR,1.339 LONG	1
54	004221	WSHR FLT .3441D1.000D.036T STL	1
55	003245	SCR CAP HEX HD .312-18X.875L	1
56	051390	SPROCKET,CHAIN--#40,.500P,11T	1
57	051424	SHEAVE,DRIVE--7.25 D.X.75 BORE	1
58	032498	ASM,PIVOT--SQUEEGEE	1
59	004297	PIN,CUTTER--.094X .750 LONG	1
60	051283	ROD--SQUEEGEE, KA-261B	1
61	033422	WDMT,SQUEEGEE--ADJUSTMENT	1
62	001468	BOLT,SQ NECK--.312-18X1.50L	4
63	027198	BRG,W/PB--.7501D,CAST IRON	2

KA-261B & KA-261BST FIG.B

SEQ NO	COMPONENT	DESCRIPTION	QUANT PER
1	032580	ASM,BATTERY--SUPPORT	1
2	032936	ASM,BAR--CONNECT,BRUSH LIFT	1
3	033513	ASM,FRAME--UPPER,KA261B	1
4	051645	PLATE, MOUNTING--SWITCH	1
5	001244	SCR MACH RD HD 6-32X.750L	2
6	005570	BOLT,EYE-- 10-24X1.25 SHANK	1
7	026515	SWITCH,PUSH--SPDT,21A,240V	1
8	005261	SCR MACH R) HD 6-32X1.25L	2
9	048648	SPRING,COM' .344D .687L .032XD	1
10	003274	NUT,HEX-- 6-12,ZN PLT	4
11	002269	SCR CAP HEX HD .250-20X1.75L	2
12	002278	WSHR LK .2621D.4890D.062TSPLT	2
13	048177	SPACER,STL--.253X.374,.530L,Z	2
14	048174	PULLEY,CABLE--2.500D,.378 BURL	2
15	003283	NUT,HEX--.250-20,ZN PLT	2
16	048771	CABLE,STL--.125DIA,.37.50L	1
17	004298	PIN,CUTTER--.125X .750 LONG	1
18	E36472-1	CUFF	2
18	032547	ASM,HUSL--VAC	1
18	051134	HOSE 5' LONG	1
19	049009	BRACKET-SQUEEGEE LIFT	1
20	004383	PIN,CLVLT--.375X .625 LONG	1

KA-261B & KA-261BST FIG.B

21	002389	SCR MACH RD HD 2-56X.500L	2
22	048507	CAP-SQUEEGEE	1
23	048652	GASKET-SQUEEGEF	1
24	048765	TUBE,PLSTC--FLNGD,1.500D,1.57L	1
25	005482	SCR TPG F PAN HD 10-24X.875L	16
26	048526	CLAMP-SQUEEGEE REAR	1
27	049909	BACKUP SQUEEGEE BLADE	1
28	048524	BODY-SQUEEGEF	1
29	038422	SQUEEGEE RUBBER SET KA260B	1
29	048527	RUBBER-SQUEEGEF FRONT	2
30	048528	CLAMP-SQUEEGEE FRONT	2
31	002371	SCR TPG F PAN HD 10-24X.625L	17
32	051191	BUMPER WHEEL-PAINTED	2
33	004219	WSHR FLT .3441D.6250D.036T STL	4
34	004212	WSHR LK .3261D.5860D.078TSPLT	2
35	003244	SCR CAP HEX HD .312-18X.750L	2
36	002375	SCR MACH FLAT HD .375-16X1.25L	1
37	002342	SCR MACH FLAT HD .375-16X3.00L	1
38	004214	WSHR LK .3901D.6830D.094TSPLT	3
39	003294	NUT,HEX JAM--.375-16,ZN PLT	4
40	005320	WSHR FLT .4061D.7500D.060T STL	2
41	002343	SCR TPG F PAN HD .250-20X.500L	8
42	005284	WSHR FLT .3441D.6870D.080T STL	4
42	048097	WSHR FLT .3281D2.270D.120T STL	2
43	003349	NUT,HEX--.312-18,ZN PLT	2
43	004212	WSHR LK .3261D.5860D.078TSPLT	4
44	048047	DRAIN CLAMP	2
45	032489	ASM,VALVE--DUMP	2
46	048783	HOSE,RBH,FLX--4.37-7.50L	2
47	049999	CLAMP,HOSE--2.25 MAX DIA,WORM	2
48	048178	WEAR STRIP-CABLE 98256	1
49	003368	NUT,HEX LOCK--.375-16,ZN PLT	2
50	048706	ANGLE,STL--1.25X1.25X21.50L	2
51	005483	WSHR FLT .4381D1.000D.104T STL	6
52	003268	SCR CAP HEX HD .375-16X3.00L	2
53	003349	NUT,HEX--.312-18,ZN PLT	4
54	004212	WSHR LK .3261D.5860D.078TSPLT	4
55	051461	SPACER,STL--1.00X2.50X2.75 L	2
56	046854	MOUNTING BLUCK	2
57	002339	SCR CAP HEX HD .312-18X5.00L	4
58	003366	NUT,SPEED,U--.250-20,.50X.97	2
59	051561	SPACER,STL--.506X.750,.437L	2
60	003364	NUT,SPEED,U--.250-20,.63X1.23	14
61	033410	WDMT,BRUSH LIFT--26" AUTO	1
62	003279	NUT,HEX-- 10-24,ZN PLT	1
63	048164	CLAMP-SQUEEGEE CENTER	1
64	048165	RUBBER-SQUEEGEE FRONT CTR	1

KA-261B & KA-261BST FIG C

SEQ NO	COMPONENT	DESCRIPTION	QUANT PER
1	003262	SCR CAP HEX HD .375-16X1.00L	3
2	004214	WSHR LK .3901D.6830D.094TSPLT	7
3	051405	BRACE,SUPPORT--BRUSH HEAD	1
4	003293	NUT,HEX--.375-16,ZN PLT	1
5	051485	SHAFT,SUPPORT--BRUSH HEAD	1
6	051652	SPACER,STL--.641X.875,3.00L,ZN	1
7	024229	MTR,DC--36V,.460HP, 320RPM	1
8	051549	LABEL, INSTR--WRN,AUTO	2
9	004326	RIVET,TUBE--.250 DIA,.719L	9
9	005373	WSHR FLT .2811D.6250D.062T STL	9
9	032231	ASM,DRIVE--BRUSH,RIGHT	1
9	033450	ASM,BRUSH--MOUNT RIGHT	1
9	046425	SPACER,PHEN--.250X.437,.250L	3
9	046764	BRUSH SUPPORT	1
9	048414	PLATE-BRUSH RING SUPPORT	1
9	049631	STRAP-BRUSH RING	3
9	052624	CASTING--BRUSH DRIVE,C/F,MACH	1
10	020274	BRUSH,FLAT--13.50D,BASSINE,WD	2
11	033418	WDMT,BRUSH HEAD--26" AUTO	1
12	033787	ASM,TEE--SOLUTION FEED,KA-261	1
13	046425	SPACER,PHEN--.250X.437,.250L	1
14	051474	CLAMP,LUOP--.609 CLOSED I.D.	2
15	005487	SCR TPG F PAN HD 10-24X.500L	2
16	032614	ASM,YDKL--BRUSH LIFT	1
17	005483	WSHR FLT .4381D1.000D.104T STL	2
18	004297	PIN,CUTTER--.094X .750 LONG	1
19	026573	CHARGER PLUG	1
20	024228	MTR,DC--36V,.460HP, 320RPM	1
21	001283	SCR MACH RD HD 10-24X.375L	2
22	003413	NUT,SPEED,U-- 10-24,.44X.63	2
23	048023	LIN) CONNECTOR	4
24	048026	CHAIN,BALL--5.75 LONG	2
25	004352	PIN,LOCK--.125 DIA WIRE	2
26	051486	PIN,ALUM.--.375" BRUSH LOCK'G	4
27	003359	NUT,HEX--.375-24,ZN PLT	2
28	048953	BALL JOINT	4
29	049473	BALL JOINT BODY	8
30	003359	NUT,HEX--.375-24,ZN PLT	8
31	051406	ROD,STL--THR,.375X.56	4
32	002237	SCR CAP HEX HD .250-20X.500L	8
33	002278	WSHR LK .2621D.4890D.062TSPLT	8
34	052623	BRACKET,ANGLE--.125X1.31X1.31	2
35	002243	SCR CAP HEX HD .250-20X.625L	2
36	002273	SCR CAP HEX HD .250-20X1.75L	2
36	003283	NUT,HEX--.250-20,ZN PLT	2

KA-261B & KA-261BST FIG C			
37	052629	RING RTNG--EXT, 1.31 SHAFT	2
38	052628	O-RING--1.3121D, 1.5620D, .125T	4
39	052612	RING, BRASS--SOLUTION FEED AUTO	2
40	052627	ADPTR, PP-HS--1/4 NPTX1/2HS, BRS	4
41	045815	KEY, SQUARE--.250 SQ, .875 LONG	2
42	005373	WSHR FLT .2811D, .6250D, .062T STL	2
42	032232	ASM, DRIVE--BRUSH, LEFT RING	1
42	033451	ASM, BRUSH--MOUNT LEFT KA261B	1
42	046425	SPACER, PHEN--.250X.437, .250L	1
42	049631	STRAP-BRUSH RING	1
42	052624	CASTING--BRUSH DRIVE, C/F, MACH	1
43	223228	SCR SET CUP PT .250-20X.500L	4
44	047834	CLAMP, HOSE--.875 MAX DIA, WORM	2
45	051643	SPRING, COMP .970D 2.50L .105WD	2
46	050979	WSHR FLT .6251D1.250D.120T STL	2
47	048979	SPRING, COMP .480D 2.25L .059WD	1
48	047085	STRAP, TIE, ELEC-- 5.50L, NYLON	1

KA-261B & KA-261BST FIG D			
SEQ NO	COMPONENT	DESCRIPTION	QUANT PER
1	025275	ASM, WIRE-- 6GA, RED, 8.0L, RINGS	4
2	025085	BATTERY CABLE	4
3	025274	ASM, WIRE-- 6GA, BLK, 14.0L, RINGS	4
4	026408	BATTERY-- 6V, 200AH, WET	1
4	026568	BATTERY PAC OF 6 DRY	1
5	048533	BATTERY TRAY	6
6	032686	BATTERY SUPPORT FRAME	1
7	051107	LID-SOLUTION TANK	1
8	051073	SOLUTION TANK-MACHINED	1
9	048817	SUPPORT-TANK	1
10	048818	GUARD-BRUSH LIFT LEVER	1
11	048848	LINE STRAINER	1
12	004385	PIN, ROLL--.500 DIA, 1.250L, SS	1
12	032714	ASM, FITTING & ROLL PIN--BRASS	1
13	048776	ADPTR, PP-HS--3/4 MPTX.500 B055	1
14	004472	WSHR FLT 1.081D, .060D W/FLAT	1
15	046980	ASM, GASKET--SCREEN	2
16	004330	WSHR FLT 1.051D1.500D.035T STL	2
17	006114	NUT, HEX LOCK--.750 IPT, CONDUIT	1
18	051603	ELBOW, PIPE--3/4 MPTX3/4IPT, BRS	1
19	003279	NUT, HEX-- 10-24, 2N PLT	1
20	048654	VALVE-WATER V-75	1
21	001295	SCR MACH HD HD 10-24X.525L	1
21	003279	NUT, HEX-- 10-24, 2N PLT	1
21	004253	WSHR LK .2041D.4100D.025T EXT	1
22	048510	PLATE	1
23	003279	NUT, HEX-- 10-24, 2N PLT	1
24	032548	ASM, CABLE--WATER	1
25	001295	SCR MACH RD HD 10-24X.625L	1
26	004253	WSHR LK .2041D.4100D.025T EXT	1
27	042113	CLAMP, LOOP--.187 DIA, STL	1
28	044811	LEVER-WATER VALVE	1
28	044826	CONNECTOR-WATER VALVE CABLE	1
29	001295	SCR MACH RD HD 10-24X.625L	1
29	004253	WSHR LK .2041D.4100D.025T EXT	1
30	026555	LINE CONNECTOR	1
31	048843	BAR, ALUM, HEX--.500, 3.00 LONG	2
32	047366	STUD-- 10-24X.50L STL	2
33	023956	MTR, VAC--36V, BYP, 2 STG, PD	1
33	032533	ASM, MOTOR--VAC	1
33	032956	ASM, MOTOR--VAC, UZH-J20D	1
33	096773	MTR, VAC--24V, BYP, 2 STG, PD	1
34	026523	BRUSH, MTR--FOR 32456	2
34	038786	BRUSH, MTR--24 AND 36V DC VAL	2
35	047348	LUG MOTOR MOUNT	1
36	046817	LINT FILTER	1
37	049355	GASKET-VAC MOTOR	1
38	048563	GASKET-VAC POT	1
39	048239	VAC POT	1
40	048881	SPACER, BRN--.130X1.00, .187L	2
41	004226	WSHR FLT .2341D1.1250D.030T STL	2
42	003279	NUT, HEX-- 10-24, 2N PLT	2
43	006019	BSHG, PIPE--3/4 MPTX1/2 IPT, BRS	1
44	048511	BRACKET	1
45	003279	NUT, HEX-- 10-24, 2N PLT	4
45	005297	WSHR LK .7001D.3340D.047TSPLT	4
45	005407	WSHR FLT .2031D.5620D.045T STL	4
45	005457	SCR MACH PAN HD 10-24X1.00L	4
46	032542	ASM, ELBOW--INLET-TOP	1
47	048257	GASKET-INLET ELBOW	1
48	048257	GASKET-INLET ELBOW	1
49	032543	ELBOW ASM-INLET-BOTTOM	1
50	001327	SCR MACH PAN HD 10-24X.7.0L	2
51	003279	NUT, HEX-- 10-24, 2N PLT	2
51	051466	CLAMP, LOOP--.297 CLOSED I.O.	4
51	224074	WSHR SEAL .2031D SS	4
52	026725	SWITCH, TILT--MERCURY, 20A, 115V	1
53	051469	VAC TANK MACHINED--KA260-BD	1
54	049028	TANK SUPPORT	1
55	051610	TUNING, SOLUTION--LINE 12.00L	1

KA-261B & KA-261BST FIG E			
SEQ NO	COMPONENT	DESCRIPTION	QUANT PER
1	032747	ASM, COVER--	1
2	048071	HANDLE, STL	1
3	048531	INSTRUMENT PANEL	1
4	048532	LABEL, INSTR--OPN, AUTO CONT	1
5	002334	SCR MACH HD HD .250-20X.750L	12
6	005213	WSHR FLT .2811D.6250D.063T STL	2
7	002278	WSHR LK .2621D.4890D.062TSPLT	8
8	002243	SCR CAP HFX HD .250-20X.625L	2
9	048672	PANEL-OUTER COVER LEFT-PTD	1
9	050072	PANEL OUTER COVER-LEFT	1
10	048671	PANEL-OUTER COVER RIGHT PTD	1
10	050073	PANEL-OUTER COVER-RIGHT	1
11	003369	NUT, HEX JAM--.625-11, 2N PLT	2
12	048788	PLATE, HANDLE LOCK	1
12	048789	PLATE-HANDLE LOCK BOTTOM	1
13	033429	WDMT, SQUEEZE BAR--KA-261B	1
14	005453	PIN, ROLL--.187 DIA, 1.000L	2
14	033427	ASM, SQUEEZE HANDLE-- KA261B	1
14	049965	HANDLE-TRACTION BAR	1
15	051409	BAR CONNECTING--ACTR-HANDLE	1
16	032958	ASM, HANDLE--BRUSH LIFT KA261B	1
17	005474	PIN, ROLL--.187 DIA, 1.375L	1
17	051415	BAR, HANDLE-RIGHT HAND, KA261B	1
17	051416	BAR, HANDLE-LEFT HAND, KA261B	1
18	004351	RING, RTNG--LXT, .500 SHAFT, C	2
19	033423	WDMT, LINKAGE ACTUATOR	1
19	048785	SPRING, EXT .250D 2.00L .026WD	1
19	051430	WIRE ROPE & TURNBUCKLE ASM.	1
19	051488	SPRING, EXT .250D 1.50L .026WD	1
20	002278	WSHR LK .2621D.4890D.062TSPLT	2
20	005423	SCR CAP HFX HD .250-20X2.00L	2
21	004298	PIN, CUTTER--.125X .750 LONG	1
22	005320	WSHR FLT .4061D.7500D.060T STL	1
23	002278	WSHR LK .2621D.4890D.062TSPLT	8
23	003283	NUT, HEX--.250-20, 2N PLT	6
23	005478	SCR MACH HD HD .250-20X.500L	6
24	005320	WSHR FLT .4061D.7500D.060T STL	2
25	046652	HANDLE-GRIPS BLUE	2
25	047418	HANDLE-GRIP	1
26	032492	ASM, HANDLE--SQUEEGEE	1
27	032544	ASM, LOCK--SQUEEGEE	1
28	004361	PIN, CLEVIS--.375X1.000 LONG	1
29	048779	CABLE, STL--.125 DIA, 36.50 LONG	1
30	049664	REAR PANEL--OUTER COVER, 261B	1
30	051058	REAR PANEL-OUTER COVER 26AFM	1
31	001372	SCR MACH PAN HD 10-24X.500L	20
32	048691	PANEL-LEFT-LOWER	1
33	003381	NUT, SPEED, FLT-- 10-24, .44X.75	16
34	048680	PANEL-RIGHT-LOWER	1
35	048078	BAR, SPACER--27 LONG	2
35	002252	SCR MACH FLAT HD .250-20X.7.0L	10
37	004331	WSHR FLT .5001D1.500D.125T NYL	2
38	005471	SCR MACH BTN HD .500-13X1.00L	2
39	033384	ASM, COVER--BRUSH, 261B AUTOS	1
39	051238	COVER, BRUSH, POLY-MACHINED, 261B	1
40	005415	SCR MACH FLAT HD .375-16X2.00L	1
41	003283	NUT, HEX--.250-20, 2N PLT	2
42	002278	WSHR LK .2621D.4890D.062TSPLT	2
43	051275	WDMT, BUMPER WHEEL MTG -- AUTOS	1
44	051276	WDMT, BAR, BUMPER WHEEL CLAMP	1
45	047484	KNOB	2
46	049261	WHEEL 3" DIA	1
47	032745	WDMT, PANEL--FRONT	1
47	033026	ASM, PANEL--FRONT	1
49	048682	WEAR STRIP-STD. PANEL FRONT	2
49	048688	INSERT ADAPTER-BRASS BARIED	2
50	048710	WEAR STRIP-UPPER FRONT PANEL	1
51	044506	COVER-BATTERIES	1
52	005407	WSHR FLT .2031D.5620D.045T STL	4
53	004253	WSHR LK .2041D.4100D.025T EXT	4
54	003279	NUT, HEX-- 10-24, 2N PLT	4
55	051430	WIRE ROPE & TURNBUCKLE ASM.	1
55	051741	GUARD, SPLASH--.124X.00X6.00L	1
57	002330	SCR TPG F PAN HD .250-20X.562L	4
57	052006	STR, STL--.062X.437X1.50 LONG	4
58	052009	CHNL, PLSTC--.750X.281X 40.12 L	1
58	052010	CHNL, PLSTC--.750X.281X 33.18 L	1
59	052035	WIRE ROPE & TURNBUCKLE, 22.00L	1

KA-261B & KA-261BST FIG F

SEQ NO	COMPONENT	DESCRIPTION	QUANT PER
1	048653	SWITCH PROTECTOR	2
2	026503	VOLTMETER	1
3	046156	BUTTON PLUG	1
4	046008	KNOB-WATER CONTROL	1
5	026507	LIGHT, INDICATOR--RED, 36VDC	1
6	026469	SWITCH, RKR--SPST, 10A, 250V, 314H	1
7	026507	LIGHT, INDICATOR--RED, 36VDC	1
8	026797	ASM, SWITCH--AUTO, VAC, HI-CAP'Y	1
9	048531	INSTRUMENT PANEL	1
10	048532	LABEL, INSTR--OPN, AUTO CUNT	1
10	047925	STRIP-VAC HOSE GUARD	2
11	002267	SCR CAP HEX HD .250-20X1.50L	4
11	002278	WSHR LK .262ID.4890D.062TSPLT	4
11	003283	NUT, HEX--.250-20, ZN PLT	4
12	004369	WSHR SHLDR. 250ID.5620U.120T, NY	4
13	048269	BAR, STL--.187X.750X 4.00 LONG	2
14	048268	SPACER, PLSTC--.500X.625, .500L	4
15	003274	NUT, HEX-- 6-32, ZN PLT	2
15	004250	WSHR LK .148ID.2500D.031TSPLT	2
15	005261	SCR MACH RD HD 6-32X1.25L	2
16	032664	ASM, SUB--CONNECTOR CHARGEW	1
17	046425	SPACER, PHEN--.250X.437, .250L	2
18	026713	SOLENOID, DOUBLE THRU#--SWITCH	2
19	033447	WDNT, REAR AXLE--KC-300	1
19	048270	JUNCTION PANEL	1
20	026504	SOLENOID	1
21	002237	SCR CAP HEX HD .250-20X.500L	6
21	002278	WSHR LK .262ID.4890D.062TSPLT	6
21	003283	NUT, HEX--.250-20, ZN PLT	6
22	026573	CHARGER PLUG	1
22	028806	FUSE-A.C.	1
22	028807	FUSE-DC	1
22	032461	CHARGER, BAT--36 VDC, 100V 60 CY	1

KA-261B & KA-261BST FIG G

SEQ NO	COMPONENT	DESCRIPTION	QUANT PER
1	025053	ASM, CABLE--BRUSH MOTOR KA261B	1
2	026717	CIRCUIT-BREAKER--35A-THERMAL	1
3	005297	WSHR LK .200ID.3340D.047TSPLT	2
4	003279	NUT, HEX-- 10-24, ZN PLT	2
5	033460	ASM, PANEL--INSTRUMENT KA-261B	1
6	025244	ASM, WIRE--2 CNOCT, 16GA, BLK	1
7	026400	NUT, WIRE--IDEAL 74B	2
8	025570	ASM, WIRE--16GA, BLK, 7.0L, QD	1
9	026464	NUT, WIRE--IDEAL 73B	4
10	026726	WIRE HARNESS--VAC TANK	1
11	026603	SWITCH, LVR--DPST, 20A, 125-250V	1
12	025571	ASM, WIRE--2 CNOCT, 16GA, BLU	1
13	025272	ASM, WIRE--16GA, BLK, 15.0L, RINGS	2
14	025636	CIRCUIT BREAKER--25AMP, SPSTNC	1

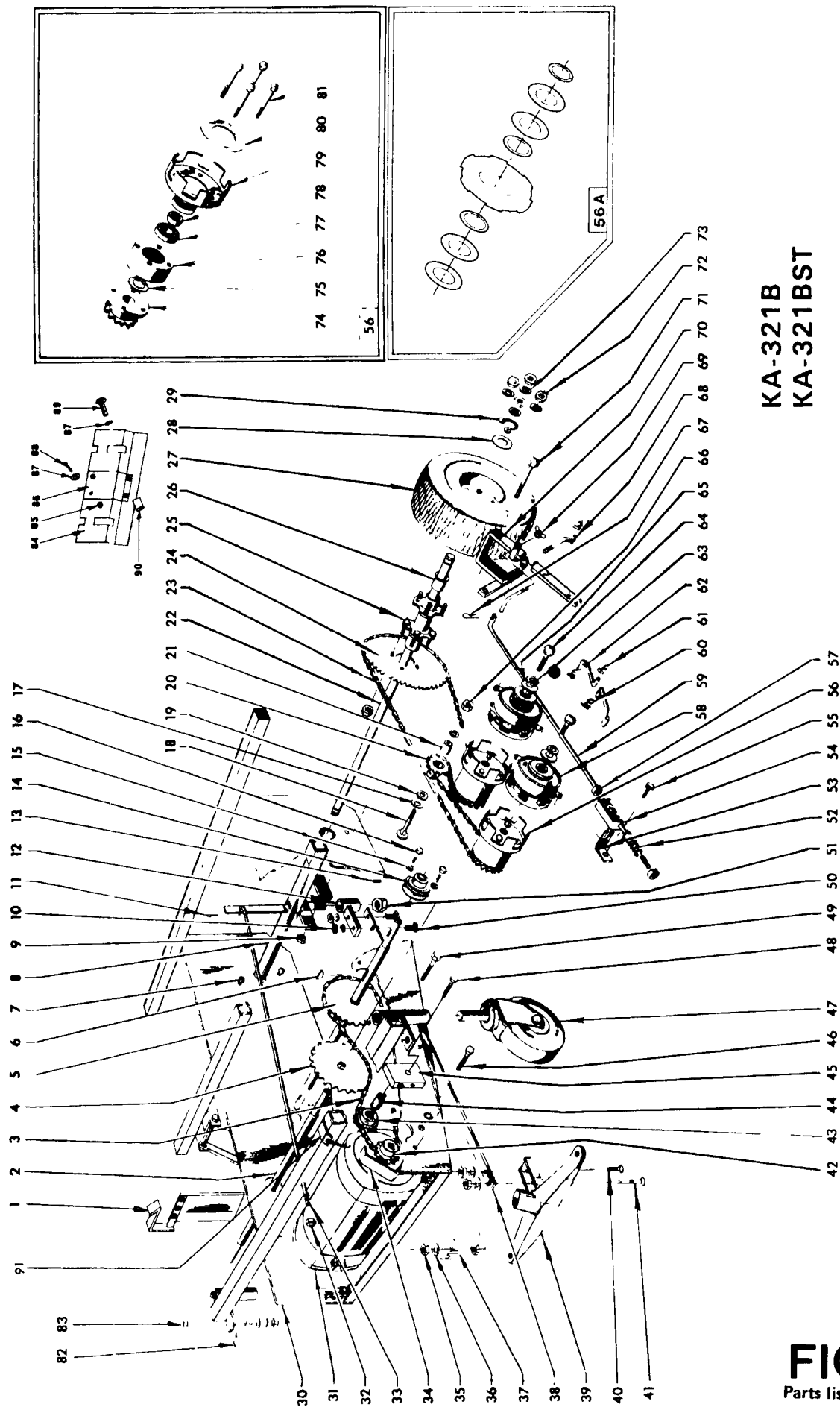

KA-321B  
KA-321BST

**FIG. A**  
Parts list on page 24

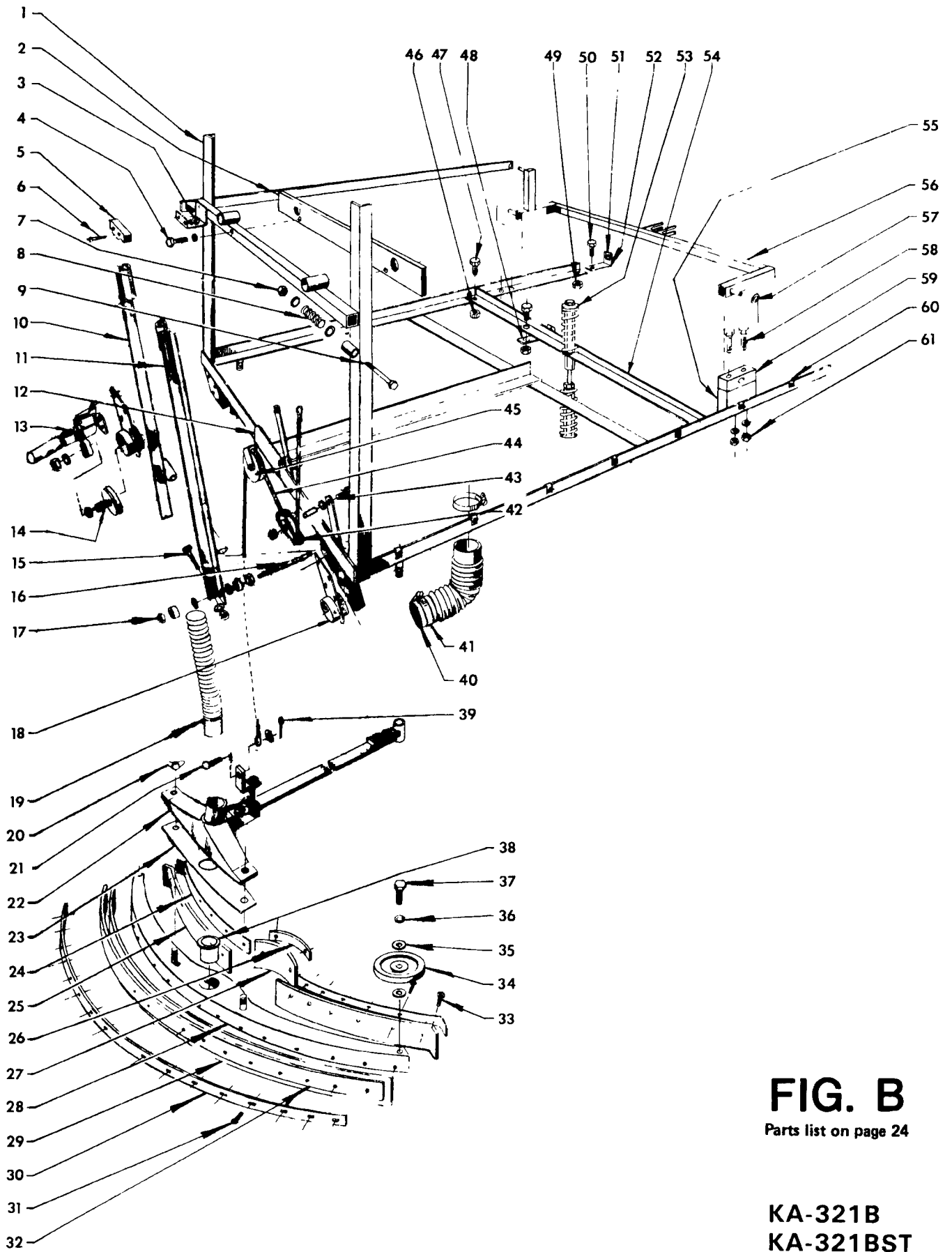

**FIG. B**

Parts list on page 24

**KA-321B  
KA-321BST**

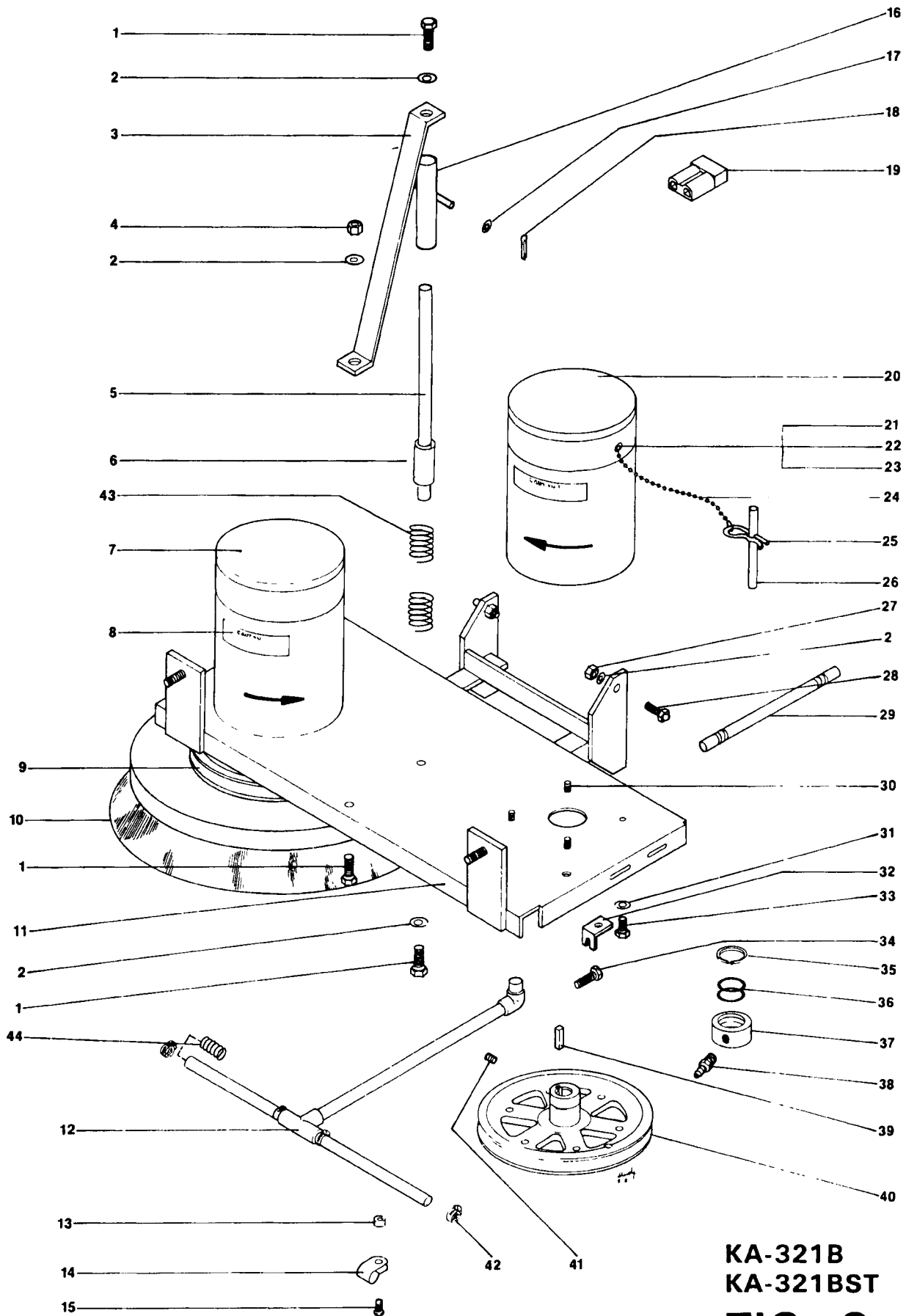

KA-321B  
 KA-321BST  
**FIG. C**  
 Parts list on page 25

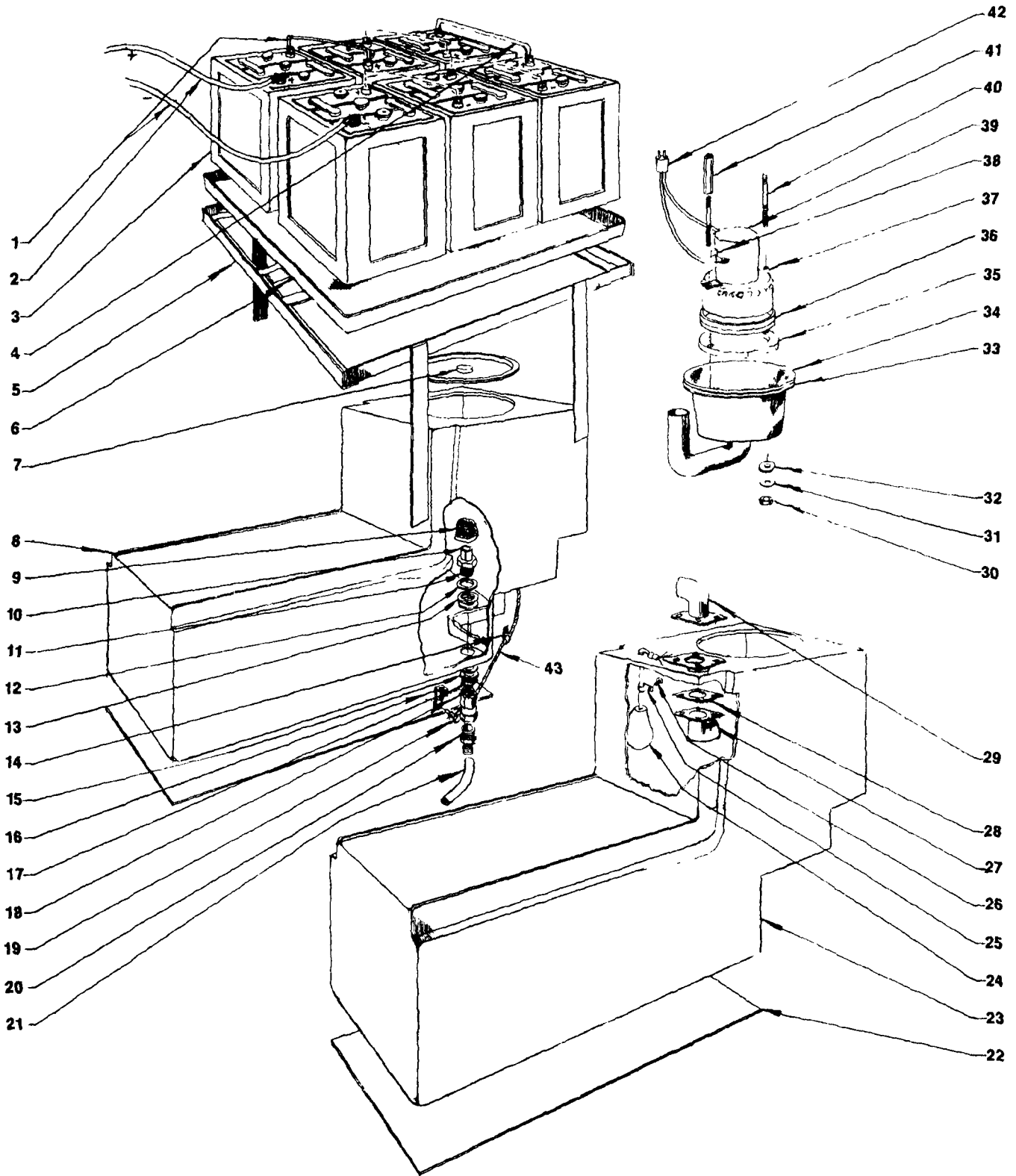

**KA-321B**  
**KA-321BST**  
**FIG. D**  
 Parts list on page 26

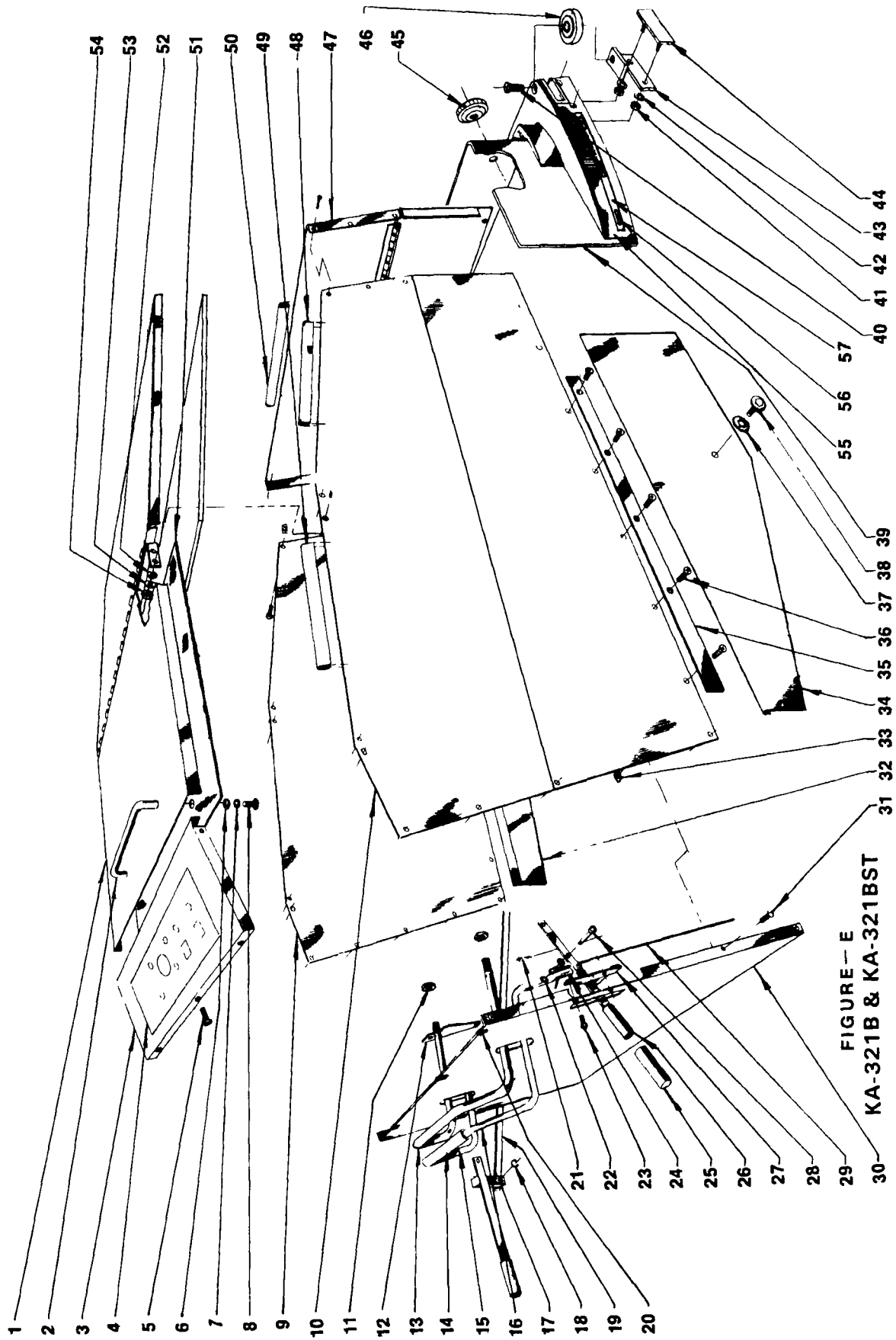
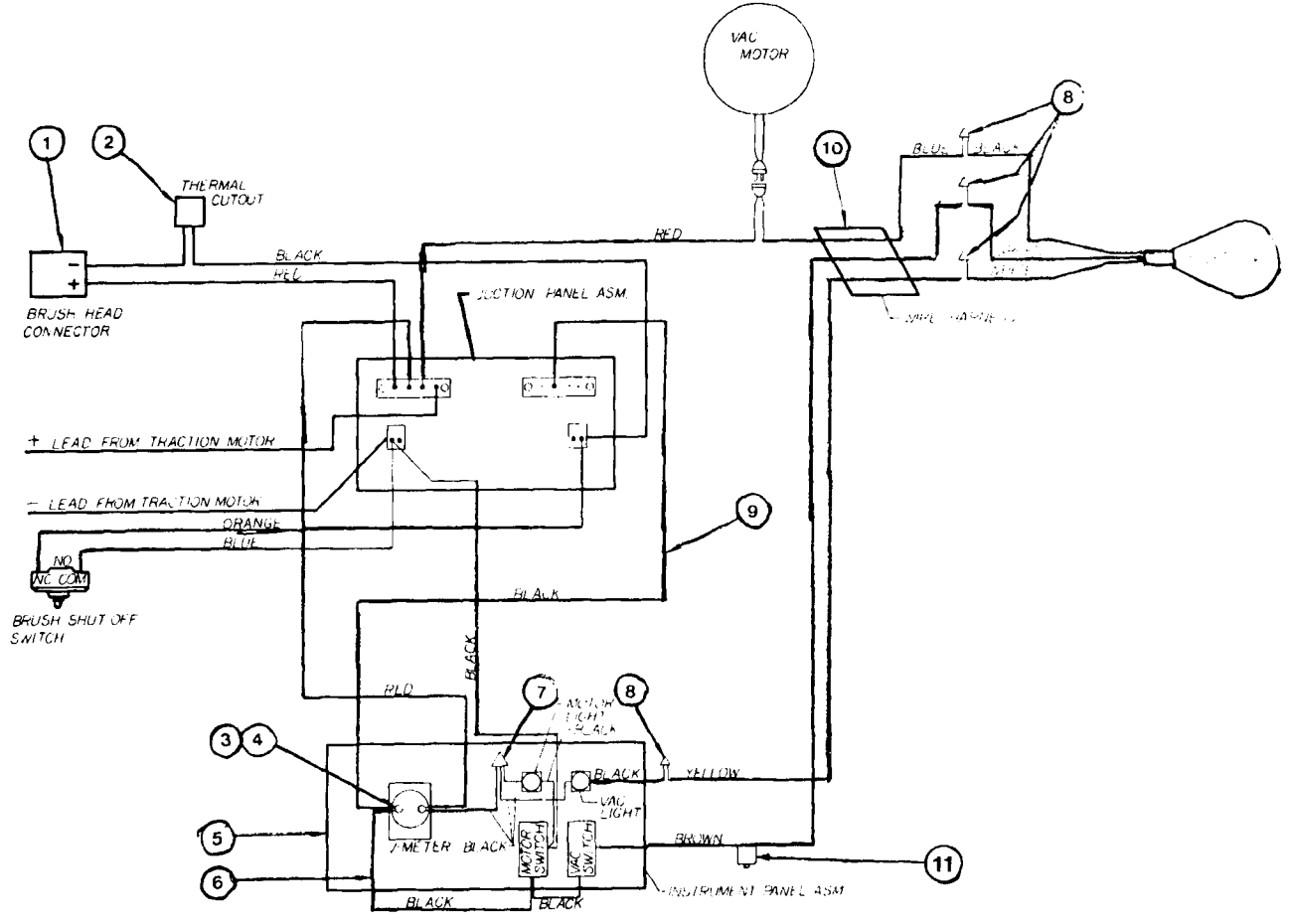
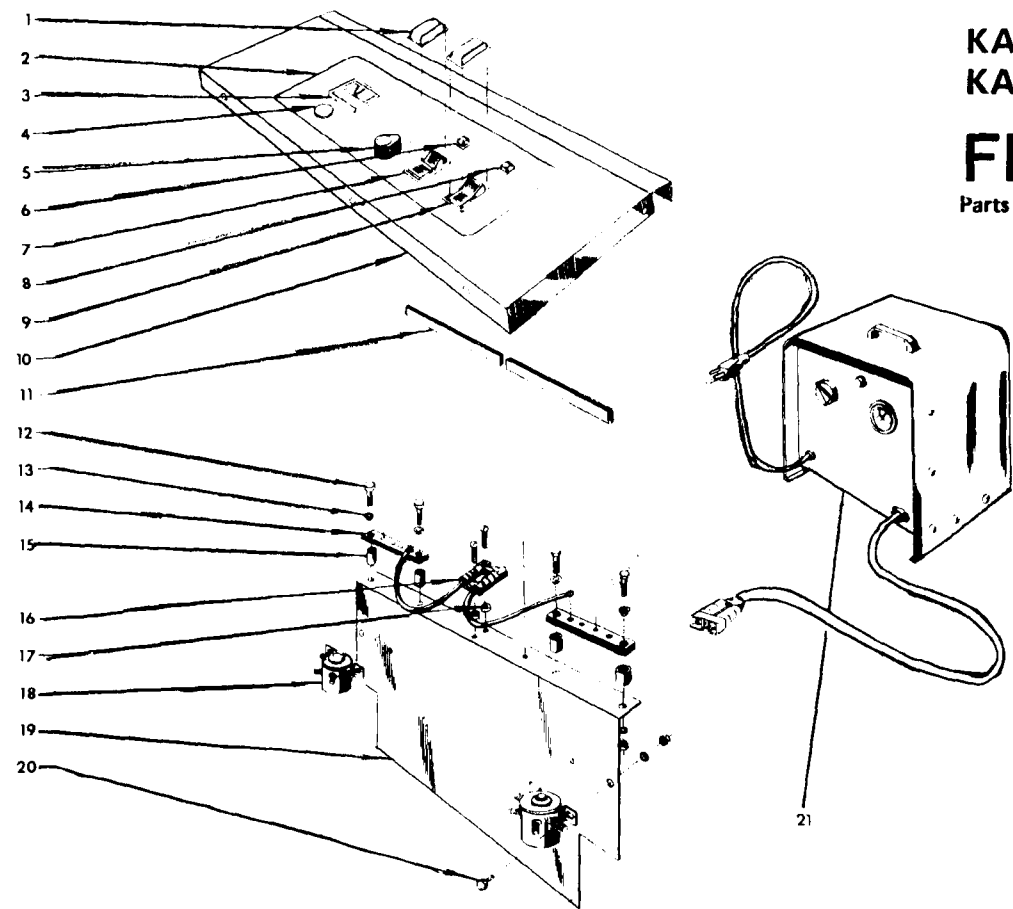

FIGURE - E  
KA-321B & KA-321BST

KA-321B  
KA-321BST

**FIG. G**  
Parts list on page 26



KA-321B & KA-321BST FIG A			
SEQ NO	COMPONENT	DESCRIPTION	QUANT PER
1	001366	SCR MACH PAN HD 10-32X.500L	3
1	033337	ASM, GUARD--SPLASH, LEFT	1
1	033339	WDMT, BRACKET--SPLASH GUARD	1
1	033356	ASM, GUARD--SPLASH, RIGHT	1
1	051105	GUARD--SPLASH	1
1	222223	NUT, HEX LOCK-- 10-32, ZINC	3
2	048999	CLUTCH SHAFT	1
3	048247	LINK, CHAIN--CONN, #35, .37P	1
3	049234	CHAIN, ROLLER--#35, .84LK	1
4	049005	SPROCKET, CHAIN--#35, .375P, 45T	1
5	049004	SPROCKET, CHAIN--#35, .375P, 40T	1
6	049017	KEY, WOODRUFF--#606, .750D, .187W	6
7	003372	NUT, HEX LOCK-- .375-24, STL	4
7	048953	BALL JOINT	1
8	032755	ASM, TUBE--SQUEEGEE, PIVOT ADJ	1
9	003368	NUT, HEX LOCK-- .375-16, ZN PLT	2
10	003349	NUT, HEX-- .312-18, ZN PLT	2
10	004212	WSHR LK .326ID.58600.078TSPLT	2
11	004297	PIN, COTTER-- .094X .750 LONG	1
12	032498	ASM, PIVOT--SQUEEGEE	1
13	223148	SCR SET CUP PT 10-32X.187L	8
14	027196	BRG, BW/S-- .750ID, 1.750D, .625W	4
15	005241	WSHR FLT .344ID.1.000D.060T STL	8
16	001338	SCR TPG F HEX HD .312-18X.625L	10
17	005227	WSHR FLT .531ID.87500.036T STL	2
18	002347	BOLT, SQ NECK-- .375-16X2.00L	2
19	004318	WSHR FLT .375ID.1.060D.120T STL	2
20	049003	SPROCKET, CHAIN--#40, .500P, 11T	2
21	048997	SPACER, STL-- .387X.625, 1.000L, C	2
22	048483	AXLE	1
23	049019	CHAIN, ROLLER--#40, 102LK & CONN	1
24	003372	NUT, HEX LOCK-- .375-24, STL	8
24	032838	ASM, HUB/SPROCKET--	2
24	049006	SPROCKET, CHAIN--#40, .500P, 60T	2
25	005512	BOLT, SLFLK HX HD .375-24X.750L	16
25	049020	ASM, HUB & BUSHING--	2
26	027193	BRG, SLV--WHEEL	4
27	049021	ASM, WHEEL & TIRE--	2
28	004330	WSHR FLT 1.050ID.500D.036T STL	2
29	048537	RING, RTNG--EXT, .984 SHAFT, 5160	2
30	032756	WDMT, CHASSIS--LOWER	1
31	023308	MTR, DC--36V, .750HP, 700RPM, 48F	1
31	026642	BRUSH, MTR--FOR 23307 & 23308	4
31	026643	ASM, RING--BRUSH	1
32	003378	NUT, HEX LOCK-- .312-18, ZN PLT	1
33	048169	ROD--SQUEEGEE	1
34	048996	BAR, SPACER--TRACTION MOTOR	1
35	003294	NUT, HEX JAM-- .375-16, ZN PLT	3
36	004214	WSHR LK .390ID.68300.094TSPLT	4
37	049009	BRACKET--SQUEEGEE LIFT	1
38	048534	BAR, STL-- .250X1.25X22.50L, SPR	1
39	048507	CAP--SQUEEGEE	1
40	002375	SCR MACH FLAT HD .375-16X1.25L	1
41	002342	SCR MACH FLAT HD .375-16X3.00L	1
42	049233	SPROCKET, CHAIN--#35, COMPLETE	1
43	048545	SPROCKET, CHAIN--#35, .375P, 13T	1
44	051274	IDLER--SHAFT--MOTOR	1
45	001327	SCR MACH PAN HD 10-24X.750L	2
45	001343	SCR CAP SOC HD 10-24X.500L	1
45	005266	SCR MACH FLAT HD .250-20X1.37L	1
45	033773	ASM, CHAIN TENSIONER--AUTO'S	1
45	052569	SPRING, EXT-- .2500X2.00LX.037WD	2
46	003251	SCR CAP HEX HD .312-18X1.75L	3
46	004212	WSHR LK .326ID.58600.078TSPLT	3
47	049940	CASTER	2
47	050600	O-RING--2.50ID 2.750D .125T	2
48	033661	ASM, GREASE FITTING--1.375 LONG	1
49	002273	SCR CAP HEX HD .250-20X1.75L	1
49	002278	WSHR LK .262ID.48900.062TSPLT	2
49	003283	NUT, HEX-- .250-20, ZN PLT	2
50	003249	SCR CAP HEX HD .312-18X1.25L	2
51	003370	NUT, HEX LOCK-- .500-13, ZN PLT	1
52	048979	SPRING, COMP .480D 2.25L .059WD	4
53	032775	ASM, STOP--SPRING	2
54	048988	BRACKET--CENTERING SPRING	2
55	001338	SCR TPG F HEX HD .312-18X.625L	1
56	032757	ASM, SPROCKET--CLUTCH	4
56	038388	CLUTCH REBUILD KIT	1
57	048987	COLLAR--CENTERING SPRING	4
58	049016	ASM, CLUTCH--	4
59	049008	ACTUATOR ROD--CLUTCH	2
60	049012	CLIP--L H	4
61	049011	CLIP--R H	8
62	049014	CLUTCH ROD LOWER	4
63	004212	WSHR LK .326ID.58600.078TSPLT	4
64	003244	SCR CAP HEX HD .312-18X.750L	4
65	004317	WSHR FLT 1.06ID.1.500D.024T STL	4
65	004427	WSHR FLT .344ID.1.250D.120T STL	4
66	005219	WSHR FLT .406ID.1.000D.071T STL	2
66	005279	NUT, HEX LOCK-- .375-16, NYLOC	2
67	004296	PIN, COTTER-- .094X .500 LONG	2
68	049013	CLUTCH ROD--UPPER	4
69	003358	NUT, WING-- 10-24, ZN PLT	4
70	032754	ASM, LINKAGE--CLUTCH	2

KA-321B & KA-321BST FIG A			
SEQ NO	COMPONENT	DESCRIPTION	QUANT PER
71	003268	SCR CAP HEX HD .375-16X3.00L	2
72	003359	NUT, HEX-- .375-24, ZN PLT	8
73	004214	WSHR LK .390ID.68300.094TSPLT	8
74	049001	SPROCKET, CHAIN--#35, .375P, 11T	4
75	004422	WSHR SPR TNSN .689ID.1.250D.010	4
76	049002	SPACER, ALUM--1.376X2.50, 1.055L	4
77	027208	BRG, BALL-- .625ID, 1.375OD, .344W	8
78	049537	SPACER, STL-- .640X.750, .387L, Z	4
79	048984	DRIVE CUP--CLUTCH	4
80	049010	WSHR FLT R5#04421 W/4 HOLES	4
81	002267	SCR CAP HEX HD .250-20X1.50L	4
81	004254	WSHR LK .267ID.51000.328T EXT	4
82	049015	BAR, STL-- .187X1.00X 2.00 LONG	2
83	003264	SCR CAP HEX HD .375-16X1.25L	2
83	003294	NUT, HEX JAM-- .375-16, ZN PLT	2
83	004214	WSHR LK .390ID.68300.094TSPLT	2
83	004384	WSHR FLT .406ID.87500.064T STL	2
84	052200	RUBBER, SPLSH GUARD--8.18X14.75L	1
85	005480	NUT, HEX LOCK-- 10-24, NYLOC	2
86	052408	PLATE, MTG--SPLASH GUARD 4.0X7	1
87	224015	WSHR FLT .187ID.1.000D.063T STL	4
88	001289	SCR MACH RD HD 10-24X.500L	2
89	005482	SCR TPG F PAN HD 10-24X.875L	2
90	050872	SPACER, PHEN-- .250X.500, .375L	2
91	052568	BAR, STL-- .125X.500X1.875 LONG	1

KA-321B & KA-321BST FIG B			
SEQ NO	COMPONENT	DESCRIPTION	QUANT PER
1	033482	WDMT, CHASSIS--UPPER KA-321B	1
2	032580	ASM, BATTERY--SUPPORT	1
3	003274	NUT, HEX-- 6-12, ZN PLT	2
3	004200	WSHR FLT .156ID.37500.065T BRS	2
3	004250	WSHR LK .148ID.25000.031TSPLT	2
4	003251	SCR CAP HEX HD .312-18X1.75L	2
4	004212	WSHR LK .326ID.58600.078TSPLT	2
5	026515	SWITCH, PUSH--SPOT, 21A, 240V	1
6	005261	SCR MACH RD HD 6-32X1.25L	2
7	003368	NUT, HEX LOCK-- .375-16, ZN PLT	2
7	005483	WSHR FLT .438ID.1.000D.104T STL	4
8	048206	SPRING, COMP .600D 1.00L .072WD	2
9	003268	SCR CAP HEX HD .375-16X3.00L	2
10	032491	ASM, LEVER--CONTROL, LEFT	1
11	032490	ASM, LEVER--CONTROL, RIGHT	1
12	048178	WEAR STRIP--CABLE 98256	1
13	002343	SCR TPG F PAN HD .250-20X.500L	8
13	048047	DRAIN CLAMP	2
14	003349	NUT, HEX-- .312-18, ZN PLT	2
14	004212	WSHR LK .326ID.58600.078TSPLT	2
14	004374	WSHR FLT .406ID.1.750D.060T STL	2
14	005284	WSHR FLT .344ID.68700.080T STL	2
14	005462	SCR CAP HEX HD .312-18X1.75L	2
14	048097	WSHR FLT .328ID.2.700D.120T STL	2
14	048140	WSHR NEOPRENE .250X2.25X.187T	2
15	003267	SCR CAP HEX HD .375-16X2.75L	2
15	003368	NUT, HEX LOCK-- .375-16, ZN PLT	2
16	049008	ACTUATOR ROD--CLUTCH	2
17	003308	NUT, HEX-- .312-24, ZN PLT	4
17	004218	WSHR FLT .344ID.75000.060T STL	4
17	048986	WSHR FLT .328ID.75000.250T RBR	4
18	032489	ASM, VALVE--DUMP	2
19	032547	ASM, HOSE--VAC	1
20	003289	NUT, WING-- .312-18, ZN PLT	2
21	004383	PIN, CLEVIS-- .375X .625 LONG	1
22	002342	SCR MACH FLAT HD .375-16X3.00L	1
22	002375	SCR MACH FLAT HD .375-16X1.25L	1
22	003249	SCR CAP HEX HD .312-18X1.25L	2
22	003294	NUT, HEX JAM-- .375-16, ZN PLT	4
22	003349	NUT, HEX-- .312-18, ZN PLT	2
22	004212	WSHR LK .326ID.58600.078TSPLT	2
22	004214	WSHR LK .390ID.68300.094TSPLT	3
22	032498	ASM, PIVOT--SQUEEGEE	1
22	032695	ASM, SPRING--SQUEEGEE	1
22	048507	CAP--SQUEEGEE	1
22	048534	BAR, STL-- .250X1.25X22.50L, SPR	1
22	049009	BRACKET--SQUEEGEE LIFT	1
23	048652	GASKET--SQUEEGEE	1
24	048167	CLAMP--SQUEEGEE FRONT	2
25	048166	RUBBER--SQUEEGEE FRONT	2
26	048164	CLAMP--SQUEEGEE CENTER	1
27	038423	SQUEEGEE RUBBER SET KA320B	1
27	048165	RUBBER--SQUEEGEE FRONT CTR	1
28	048048	SQUEEGEE BODY	1
29	048168	RUBBER--SQUEEGEE REAR	1
30	048163	CLAMP--SQUEEGEE RIAR	1
31	003416	SCR TPG F WSH HD 10-24X.875L	20
32	049910	BACK UP SQUEEGEE BLADE	1
33	002367	SCR TPG F WSH HD 10-24X.625L	21
34	051191	BUMPER WHEEL--PAINTED	2
35	004219	WSHR FLT .344ID.62500.036T STL	2
36	004212	WSHR LK .326ID.58600.078TSPLT	2
37	003249	SCR CAP HEX HD .312-18X1.25L	2
39	048765	TUBE, PLSTC--FLNGD, 1.500D, 1.57L	1
39	004298	PIN, COTTER-- .125X .750 LONG	2
39	005320	WSHR FLT .406ID.75000.060T STL	1

KA-321B & KA-321BST FIG B			
40	048783	HOSE,RBR,FLEX--4.37 7.50L	<
41	049999	CLAMP,HOSE--2.25 MAX DIA,WORM	2
42	048176	GUARD-PULLEY	2
43	002269	SCR CAP HEX HD .250-20X1.25L	2
43	002278	WSHR LK .262ID.48900.062TSPLT	2
43	003283	NUT,HEX--.250-20,ZN PLT	2
43	048177	SPACER,STL--.253X.374,.530L,Z	2
44	048771	CABLE,STL--.125DIA,37.50L	1
45	048174	PULLEY,CABLE--2.500D,.373 BORE	2
46	003349	NUT,HEX--.312-18,ZN PLT	3
46	004212	WSHR LK .326ID.58600.078TSPLT	3
47	003228	SCR CAP HEX HD .375-16X.875L	3
48	048248	BRACKET-CABLE CLAMP	1
49	004212	WSHR LK .326ID.58600.073TSPLT	2
50	003228	SCR CAP HEX HD .375-16X.875L	2
51	003366	NUT,SPEED,U--.250-20,.50X.97	2
52	051391	BRACKET,ANGLE--FRONT PANEL MTG	2
53	003294	NUT,HEX JAM--.375-16,ZN PLT	2
53	004214	WSHR LK .390ID.68300.094TSPLT	1
53	004352	PIN,LOCK--.125 DIA WIRE	2
53	004499	WSHR FLT .594ID1.1200.063T STL	2
53	033517	WDMT,SPRING ADJMT--KA-321B	1
53	051041	BAR,HEX STL--.50X4.19L	1
53	051643	SPRING,COMP .970D 2.50L .105WD	3
53	051646	SPACER,STL--.375X.750,.750L	2
54	051552	ANGLE,STL--1.25X1.25X24.00L	1
55	051461	SPACER,STL--1.00X2.50X2.75 L	2
56	033411	WDMT,BRUSH LIFT--32" AUTO	1
56	033796	WDMT BRUSH LIFT--32 AUTO HD	1
57	047714	SPACER,STL--.500X.750,.187L	2
58	002339	SCR CAP HEX HD .312-18X5.00L	4
59	046854	Mounting Block	2
60	003364	NUT,SPEED,U--.250-20,.63X1.23	14
61	003349	NUT,HEX--.312-18,ZN PLT	4
61	004212	WSHR LK .326ID.58600.079TSPLT	4

KA-321B & KA-321BST FIG C			
SEQ NO	COMPONENT	DESCRIPTION	QUANT PER
1	003262	SCR CAP HEX HD .375-16X1.00L	3
2	004214	WSHR LK .390ID.68300.094TSPLT	7
3	051405	BRACE,SUPPORT--BRUSH HEAD	1
4	003293	NUT,HEX--.375-16,ZN PLT	1
5	051485	SHAFT,SUPPORT--BRUSH HEAD	1
6	051652	SPACER,STL--.641X.875,3.00L,ZN	1
7	024229	MTR,DC--36V,.460HP,320RPM	1
7	024290	MTR,DC--36V,.75HP,320RPM,56M	1
8	051549	LABEL,INSTR--WRN,AUTO	2
9	004326	RIVET,TUBE--.250 DIA,.719L	9
9	005373	WSHR FLT .281ID.62500.062T STL	9
9	032231	ASM,DRIVE--BRUSH,RIGHT	1
9	038853	Kit, drive hub RIGHT	1
9	046425	SPACER,PHEN--.250X.437,.250L	3
9	046764	BRUSH SUPPORT	1
9	048414	PLATE-BRUSH RING SUPPORT	1
9	049631	STRAP-BRUSH RING	3
9	052624	CASTING--BRUSH DRIVE,C/F,MACH	1
10	020274	BRUSH,FLAT--13.500,GASSINE,WD	2
11	033418	WDMT, BRUSH HEAD--26" AUTO	1
12	033788	ASM,TEL--SOLUTION FEED,KA-321	1
13	046425	SPACER,PHEN--.250X.437,.250L	1
14	051474	CLAMP,LOOP--.609 CLOSED I.D.	2
15	005467	SCR TPG F PAN HD 10-24X.500L	2
16	032614	ASM,YOKL--BRUSH LIFT	1
17	005483	WSHR FLT .438ID1.0000.104T STL	2
18	004297	PIN,COTTER--.094X .750 LONG	2
19	026573	CHARGER PLUG	1
20	024228	MTR,DC--36V,.460HP,320RPM	1
20	024290	MTR,DC--36V,.75HP,320RPM,56M	1
21	001283	SCR MACH RD HD 10-24X.375L	2
22	003413	NUT,SPEED,U-- 10-24,.44X.63	2
23	048023	END CONNECTOR	4
24	048026	CHAIN,BALL--5.75 LONG	2
25	004352	PIN,LOCK--.125 DIA WIRE	2
26	051486	PIN,ALUM--.375" BRUSH LOCK'G	2
27	003359	NUT,HEX--.375-24,ZN PLT	4
28	048953	BALL JOINT	4
29	049027	BALL JOINT LINK	4
30	002237	SCR CAP HEX HD .250-20X.500L	8
31	002278	WSHR LK .262ID.48900.062TSPLT	8
32	052623	BRACKET,ANGLE--.125X1.31X1.31	2
33	002243	SCR CAP HEX HD .250-20X.625L	2
34	002273	SCR CAP HEX HD .250-20X1.75L	2
35	052629	RING RING--EXT,1.31 SHAFT	2
36	052628	O-RING--1.312ID,1.562OD,.125T	4
37	052612	RING,BRASS--SOLUTION FEED AUTO	2
38	052627	ADPTR,PP-HS--1/4 NPTX1/2HS,URS	2
39	045815	KLY,SQUARE--.250 SQ,.875 LONG	2
40	005373	WSHR FLT .281ID.62500.062T STL	9
40	032232	ASM,DRIVE--BRUSH,LEFT RING	1
40	035572	LEFT	1
40	046425	SPACER,PHEN--.250X.437,.250L	3
40	049631	STRAP-BRUSH RING	3
40	052624	CASTING--BRUSH DRIVE,C/F,MACH	1
41	223228	SCR FLT CUP PT .250-20X.500L	4

KA-321B & KA-321BST FIG C			
42	047834	CLAMP,HOSE--.875 MAX DIA,WORM	2
43	048481	SPRING,COMP .845D 3.00L .085WD	2
44	048979	SPRING,COMP .840D 2.25L .059WD	1
45	047085	STRAP,TIE,ELEC-- 5.50L,NYLON	1

KA-321B & KA-321BST FIG D			
SEQ NO	COMPONENT	DESCRIPTION	QUANT PER
1	025085	BATTERY CABLE	5
2	025275	ASM,WIRE-- 6GA,RED, 8.0L,RINGS	1
3	026512	BATTERY-- 6V,275AH,WFT	6
3	026570	BATTERY PAL OF 6 DRY	1
4	025274	ASM,WIRE-- 6GA,BLK,14.0L,RINGS	1
5	032938	FRAMC - BATTERY SUPPORT	1
6	048643	TRAY BATTERY	1
7	051107	LID-SOLUTION TANK	1
8	051449	SOLUTION TANK--MACHINED	1
9	048848	LINE STRAINER	1
10	004385	PIN,ROLL--.500 DIA,1-250L,SS	1
10	032714	ASM,FITTING 6 ROLL PIN--BRASS	1
11	048776	ADPT4,PP-BJ--3/4 MPTX.500 BOSS	1
12	004472	WSHR FLT 1.081D.2.060D W/FLAT	1
13	046980	ASM,GASKET--SCREFN	2
14	001289	SCR MACH RD HD 10-24X.500L	1
14	003279	NUT,HEX-- 10-24,ZN PLT	1
14	005297	WSHR LK .200ID.33400.047TSPLT	1
14	042113	CLAMP,LOOP--.187 DIA,STL	1
15	004330	WSHR FLT 1.051ID1.5000.036T STL	2
16	001295	SCR MACH RD HD 10-24X.625L	1
16	003279	NUT,HEX-- 10-24,ZN PLT	1
16	004253	WSHR LK .204ID.4100D.025T EXT	1
16	051615	LEVER,WATER--VALVE	1
17	006114	NUT,HEX LOCK--.750 IPT,CONDUIT	1
18	032697	ASM,VALVE--WATER	1
18	048654	VALVE-WATER V-75	1
19	044826	CONNECTOR-INLET VALVE CABLE	1
20	006130	ELBOW,PP-HS--3/4 MPTX1/24S,PLS	1
21	048819	TUBE,VINYL--.500X.750,18.00L	1
22	049028	TANK SUPPORT	2
23	051448	VAC TANK--MACHINED,0.DRIVE	1
24	026725	SWITCH,TILT--MERCURY,20A,115V	1
25	051466	CLAMP,LOOP--.297 CLOSED I.D.	2
26	001327	SCR MACH PAN HD 10-24X.750L	2
26	224074	WSHR SEAL .203ID SS	4
27	032543	ELBOW ASM-INLET-BOTTOM	1
28	048257	GASKET-INLET LHWD	1
29	003279	NUT,HEX-- 10-24,ZN PLT	4
29	005297	WSHR LK .200ID.33400.047TSPLT	4
29	005457	SCR MACH PAN HD 10-24X1.00L	4
29	032542	ASM,ELBOW--INLET-TOP	1
30	003279	NUT,HEX-- 10-24,ZN PLT	2
31	004226	WSHR FLT .234ID1.12500.036T STL	2
32	048881	SPACER,RBR--.130X1.00,.187L	2
33	048239	VAC POT	1
34	048563	GASKET-VAC POT	2
35	049355	GASKET-VAC MOTOR	1
36	046817	LINT FILTER	1
37	005487	SCR TPG F PAN HD 10-24X.500L	2
37	047348	LUG MOTOR MOUNT	2
38	026523	BRUSH,MTR--F0H J2456	2
38	038786	BRUSH,MTR--24 AND 36V DC VAC	2
39	023956	MTR,VAC--36V,BYP,2 STG,PD	1
39	032533	ASM,MOTOR--VAC	1
39	032956	ASM,MOTOR--VAC,UZB-3200	1
39	096773	MTR,VAC--24V,BYP,2 STG,PD	1
40	047366	STUD-- 10-24X.50L STL	2
41	048843	BAR,ALUM,HEX--.500,3.00 LONG	2
42	026555	LINE CONNECTOR	2
43	032548	ASM,CABLE--WATER	1

KA-321B & KA-321BST FIG E			
SEQ NO	COMPONENT	DESCRIPTION	QUANT PER
1	032746	ASM,COVER--	1
2	048071	HANDLE,STL	1
3	033489	ASM,INSTRUMENT PANEL--KA-321B	1
4	048532	LABEL,INSTR--JPN,AUTO COAT	1
5	002334	SCR MACH RD HD .250-20X.750L	11
6	005213	WSHR FLT .281ID.56200.061T STL	2
7	002278	WSHR LK .262ID.48900.062TSPLT	2
8	002243	SCR CAP HEX HD .250-20X.625L	2
9	048672	PANEL-OUTER COVER LEFT-PTD	1
9	050072	PANEL-OUTER COVER-LEFT	1
10	048671	PANEL-OUTER COVER RIGHT PTD	1
10	050073	PANEL-OUTER COVER-RIGHT	1
11	003369	NUT,HLX JAM--.312-18,ZN PLT	2
12	048788	PLATE,HANDLE LOCK	1
12	048789	PLATE-HANDLE LOCK BOTTOM	1
13	004364	PIN,ROLL--.125 DIA,1.000	2
13	048172	SQUEEZE HAIF	1
13	050979	WSHR FLT .204ID.4100D.025T STL	6
14	004364	PIN,ROLL--.125 DIA,1.000	2
14	048173	GRIP,HANDL --1.00 DIA,11.00L	1
15	048190	CONTROL ROD-LEFT	1

KA-321B & KA-321BST FIG E			
16	048171	CONTROL ROD-RIGHT	1
17	032958	ASM,HANDLE--BRUSH LIFT KA26F	1
18	004351	RING,RTNG--EXT,.500 SHAFT, E	2
19	004297	PIN,COTTER--.094X .750 LONG	1
19	033487	ASM,CONNECTING BAR--BRUSH LIFT	1
20	003366	NUT,SPEED,U--.250-20,.50X.97	5
21	004298	PIN,COTTER--.125X .750 LONG	2
22	004364	PIN,ROLL--.125 DIA,1.000L	2
23	003283	NUT,HEX--.250-20,ZN PLT	6
23	005478	SCR MACH RD HD .250-20X.500L	8
24	005320	WSHR FLT .4061D.750DD.060T STL	2
25	046652	HANDLE-GRIPS BLUE	2
25	047418	HANDLE-GRIP	1
26	032492	ASM,HANDLE--SQUEEGEE	1
27	032544	ASM,LOCK--SQUEEGEE	1
28	004383	PIN,CLEVIS--.375X .625 LONG	1
29	048771	CABLE,STL--.1250IA,37.50L	1
30	051558	PANEL REAR--OUTER COVER KA321B	1
30	052602	PANEL,REAR--STAINLESS STL,321	1
31	001372	SCR MACH PAN HD 10-24X.500L	16
32	048681	PANEL-LEFT-LOWER	1
33	003381	NUT,SPEED,FLT-- 10-24,.44X.75	11
34	048680	PANEL-RIGHT-LOWER	1
35	047075	SPACER,STL--.506X.750,1.000L,Z	2
36	002252	SCR MACH FLAT HD .250-20X.750L	10
37	004331	WSHR FLT .5001D1.5000.125T NYL	2
38	002348	SCR MACH RD HD .500-13X2.00L	2
38	047075	SPACER,STL--.506X.750,1.000L,Z	2
39	051237	Z COVER,BRUSH POLY-MACHINED,321*	1
40	005415	SCR MACH FLAT HD .375-16X2.00L	1
41	003283	NUT,HEX--.250-20,ZN PLT	2
42	002278	WSHR LK .2621D.4890D.062TSPLT	2
43	051275	WDMT,BUMPER WHEEL MTG -- AUTOS	1
44	051276	WDMT,BAR,BUMPER WHEEL CLAMP	1
45	047484	KNUB	2
46	111639	WHEEL 4X1/2 GREY	1
47	033486	ASM,FRONT PANEL--KA-321 B	1
47	033780	ASM,FRONT PANEL--S.STEEL,KA321	1
48	048682	WEAR STRIP-SIDE PANEL FRONT	2
49	048683	WEAR STRIP-SIDE PANEL REAR	2
50	048684	WEAR STRIP-UPPER FRONT PANEL	1
51	048506	COVER-BATTERIES	1
52	005407	WSHR FLT .2031D.5620D.045T STL	4
53	004253	WSHR LK .2041D.4100D.025T EXT	4
54	003279	NUT,HEX-- 10-24,ZN PLT	4
55	051742	GUARD,SPLASH--.12X4.00X74.62L.	1
56	002390	SCR TPG F PAN HD 8-10X.562L	10
56	052006	STR,STL--.062X.437X1.50 LONG	10
57	052007	CHNL,PLSTC--.750X.281X 46.00 L	1
57	052008	CHNL,PLSTC--.750X.281X 14.00 L	1

KA-321B & KA-321BST FIG G			
SEQ NO	COMPONENT	DESCRIPTION	QUANT PER
1	025053	ASM,CABLE--BRUSH MOTOR KA261B	1
2	026717	CIRCUIT-BREAKER--35A-THERMAL	1
2	026866	CIRCUIT BREAKER--50AMP,125/230	1
3	005297	WSHR LK .2001D.334GD.047TSPLT	2
4	003279	NUT,HEX-- 10-24,ZN PLT	2
5	033489	ASM,INSTRUMENT PANEL--KA-321B	1
6	025244	ASM,WIRE--2 CNDCT,16GA,BLK	1
7	026400	NUT,WIRE--IDEAL 74B	1
8	026464	NUT,WIRE--IDEAL 73B	4
9	025272	ASM,WIRE--16GA,BLK,15.0L,RINGS	1
10	026726	WIRE HARNESS--VAC TANK	1
11	025636	CIRCUIT BREAKER--25AMP,SPSTNC	1

KA-321B & KA-321BST FIG F			
SEQ NO	COMPONENT	DESCRIPTION	QUANT PER
1	048653	SWITCH PROTECTOR	2
2	048532	LABEL,INST--OPN,AUTO CONT	1
3	026503	VOLTMETER	1
4	046156	BUTTON PLUG	1
5	046008	KNOB-WATER CONTROL	1
6	025316	INDICATOR LIGHT S/A	1
7	026469	SWITCH,RKR--SPST,10A,250V,314H	1
8	026507	LIGHT,INDICATOR--RED,36VDC	1
9	026797	ASM, SW TCT--AUTO,VAC,HI-CAPTY	1
10	051548	PANEL,INSTRUMENT--KA-321B	1
11	047925	STRIP-VAC HOSE GUARD	2
12	002267	SCR CAP H X HD .250-20X1.50L	4
13	004369	WSHR SHLDR.2501D.5620D.120T,NY	4
14	048249	BAR,STL--.187X.750X 4.00 LONG	2
15	048248	SPACER,PLSTC--.500X.625, .500L	4
16	001248	SCR MACH RD HD 6-32X1.00L	2
16	003274	NUT,HEX-- 6-32,ZN PLT	2
16	026573	CHARGER PLUG	1
16	032664	ASM,SUB--CONNECTOR CHARGER	1
17	046425	SPACER,PHE I--.250X.437, .250L	2
18	026504	SOLENOID	1
19	048270	JUNCTION PANEL	1
20	002237	SCR CAP H X HD .250-20X.500L	4
20	002278	WSHR LK .2621D.4890D.062TSPLT	4
20	003283	NUT,HEX--.250-20,ZN PLT	8
21	026573	CHARGER PLUG	1
21	028806	FUSE-A.C.	1
21	028807	FUSE-DC	1
21	032461	CHARGER,HAT--36 VDC,100V 60 CY	1

# THE KENT LIMITED WARRANTY

Your Kent Equipment, which has been manufactured, tested and inspected in accordance with carefully specified engineering requirements, is warranted to be free from defects in material and workmanship.

This warranty is, however, subject to the following qualifications, conditions, and limitations which are set forth to provide you and all users of the Kent Equipment with information concerning the duration, extent, availability, and applicability of this Kent Limited Warranty, the procedure to be taken to obtain its performance, and other information concerning the Kent Warranty policy.

## DURATION OF WARRANTY AND TO WHOM EXTENDED

This warranty extends for a period of one year from the date of the original purchase of the Kent Equipment by the original purchaser.

## PARTS OF KENT EQUIPMENT NOT COVERED BY WARRANTY

Certain parts of Kent Equipment require replacement in the ordinary course of use due to normal wear by reason of their characteristics. These are normal wear items such as cords, gaskets, switches, bumpers, carbon brushes, handle grips, bags, hoses, bearings, etc.

## EXCEPTIONS AND EXCLUSIONS FROM WARRANTY

This equipment is required to be used on electric current as indicated on the name plate. Otherwise damage, defects, malfunctions or other failures of the equipment arising from use on electric current not as indicated are excepted and excluded from this warranty.

Defects, malfunctions, failure or damage of the equipment caused by improper, unreasonable or negligent use or abuse while in the possession of the purchaser are likewise excluded from this warranty.

If repair is done on your equipment by anyone other than those below designated as authorized to perform such work without first having obtained factory instructions, The Kent Company, at its sole option, may determine that this warranty will not apply and that reimbursement for such repair will not be made because of the failure to comply with such factory specified instructions.

## FIVE YEAR POLY COMPONENT WARRANTY

Your Kent rotational molded polyethylene parts have been manufactured, tested and inspected in accordance with carefully specified engineering requirements and are warranted to be free from defects in material and workmanship.

This warranty extends for a period of five (5) years from the date of the original purchase of the Kent equipment by the original purchaser.

This warranty will not cover damage attributable to the following:

- (1) Improper, unreasonable or negligent use or abuse of the equipment.
- (2) Use of the equipment with hot water or high temperatures above 130° Fahrenheit (54° Centigrade).
- (3) "Warping", "creeping" or "distortion" of part so long as the same does not interfere with normal operation.
- (4) Abrasions or punctures of the equipment.

## PROCEDURE TO BE TAKEN TO OBTAIN PERFORMANCE OF WARRANTY

### REPAIR

To secure repair of the equipment or any warranted parts under this warranty, the following procedure should be taken.

The inoperative equipment or warranted parts, together with satisfactory evidence of the purchase date, must be delivered, with shipping and delivery charges prepaid, to one of the following:

- 1) The Dealer from whom purchased;
- 2) Any Kent distributor's Service Department in the United States;
- 3) Any Kent Authorized Service Station in the United States.

If you are unable to locate any of the foregoing, you may write or otherwise communicate with The Kent Company, Division of Dometic Incorporated, for instructions before repair service is performed by anyone else. In such event, The Kent Company will provide either the location of a closely available Kent distributor Service Department or Kent Authorized Service Station or other factory instructions.

Upon compliance with the above procedure, all warranted defects will be repaired, at no additional charge or costs to the customer, and the repaired product returned to the customer, with all shipping and delivery charges prepaid.

In following the procedures above set forth, PLEASE MAKE CERTAIN to state the Kent model, type and serial number as shown on the name plate of the equipment.

### REPLACEMENT

In the event of a defect, malfunction or failure of your Kent Equipment or any warranted part to conform with this warranty, The Kent Company may, at its sole option and own expense, replace the equipment or any warranted part with another new identical or reasonably equivalent model or part in lieu of repairing the defect.

## NO REFUND OF PURCHASE PRICE

The Kent Company will not, as a matter of its warranty policy, refund the customer's purchase price.

## WARRANTY REGISTRATION CARD FOR YOUR KENT EQUIPMENT AND REQUESTS FOR INFORMATION

Your Kent Company Distributor from whom you purchased your equipment is responsible for the registration of your warranty with the factory. We ask that you cooperate with your Distributor in supplying the necessary information on the warranty card so that we may better serve you.

Any information or questions you may have concerning your Kent Equipment or this warranty may likewise be secured from the factory.

This warranty gives you specific legal rights, and you may also have other rights which vary from state to state.

THE KENT COMPANY - P.O. BOX 1665 - ELKHART, INDIANA 46515